

DATA SHEET



Three Phase Induction Motor - Squirrel Cage

Customer :					
Product line		: Rolled Steel Jet Pump - J type Premium Efficiency Three-Phase		Product code : 13521998	
			Catalog # :	00236ET3EJP56J-S	
Frame	: 56HJ	Cooling method	: IC411 - TEFC		
Insulation class	: F	Mounting	: F-1		
Duty cycle	: Cont.(S1)	Rotation ¹	: CCW		
Ambient temperature	: -20°C to +40°C	Starting method	: Direct On Line		
Altitude	: 1000 m.a.s.l.	Approx. weight ²	: 39.9 lb		
Protection degree	: IP55	Moment of inertia (J)	: 0.1279 sq.ft.lb		
Design	: B				
Output [HP]	2	2	2		
Poles	2	2	2		
Frequency [Hz]	60	50	50		
Rated voltage [V]	230/460	190-220/380	415		
Rated current [A]	4.94/2.47	5.94-5.13/2.97	2.77		
L. R. Amperes [A]	48.9/24.5	44.0-38.0/22.0	24.4		
LRC [A]	9.9x(Code L)	7.4x(Code J)	8.8x(Code K)		
No load current [A]	2.13/1.06	2.10-1.81/1.05	1.20		
Rated speed [RPM]	3520	2875	2900		
Slip [%]	2.22	4.17	3.33		
Rated torque [ft.lb]	2.98	3.65	3.62		
Locked rotor torque [%]	250	229	280		
Breakdown torque [%]	300	280	340		
Service factor		1.15	1.15		
Temperature rise	80 K	80 K	80 K		
Locked rotor time	23s (cold) 13s (hot)	21s (cold) 12s (hot)	18s (cold) 10s (hot)		
Noise level ²	68.0 dB(A)	65.0 dB(A)	65.0 dB(A)		
Efficiency (%)	25%	82.1	84.8	83.3	
	50%	82.5	84.0	83.3	
	75%	85.5	84.6	84.9	
	100%	85.5	83.3	84.5	
Power Factor	25%	0.45	0.51	0.45	
	50%	0.73	0.79	0.73	
	75%	0.83	0.88	0.84	
	100%	0.89	0.92	0.89	
Bearing type	: <u>Drive end</u> 6203 2RS	<u>Non drive end</u> 6202 2RS	Foundation loads		
Sealing	: V'Ring	Without Bearing Seal	Max. traction	: 101 lb	
			Max. compression	: 141 lb	
Lubrication interval	: -	-			
Lubricant amount	: -	-			
Lubricant type	: Mobil Polyrex EM				
Notes USABLE @208V 5.46A SF 1.00 SFA 5.46A					
This revision replaces and cancel the previous one, which must be eliminated. (1) Looking the motor from the shaft end. (2) Measured at 1m and with tolerance of +3dB(A). (3) Approximate weight subject to changes after manufacturing process. (4) At 100% of full load.			These are average values based on tests with sinusoidal power supply, subject to the tolerances stipulated in NEMA MG-1.		
Rev.	Changes Summary		Performed	Checked	Date
Performed by					
Checked by				Page	Revision
Date	13/02/2023			1 / 16	

TORQUE AND CURRENT VS SPEED CURVE

Three Phase Induction Motor - Squirrel Cage



Customer :

Product line : Rolled Steel Jet Pump - J type Premium
Efficiency Three-Phase

Product code : 13521998

Catalog # : 00236ET3EJP56J-S

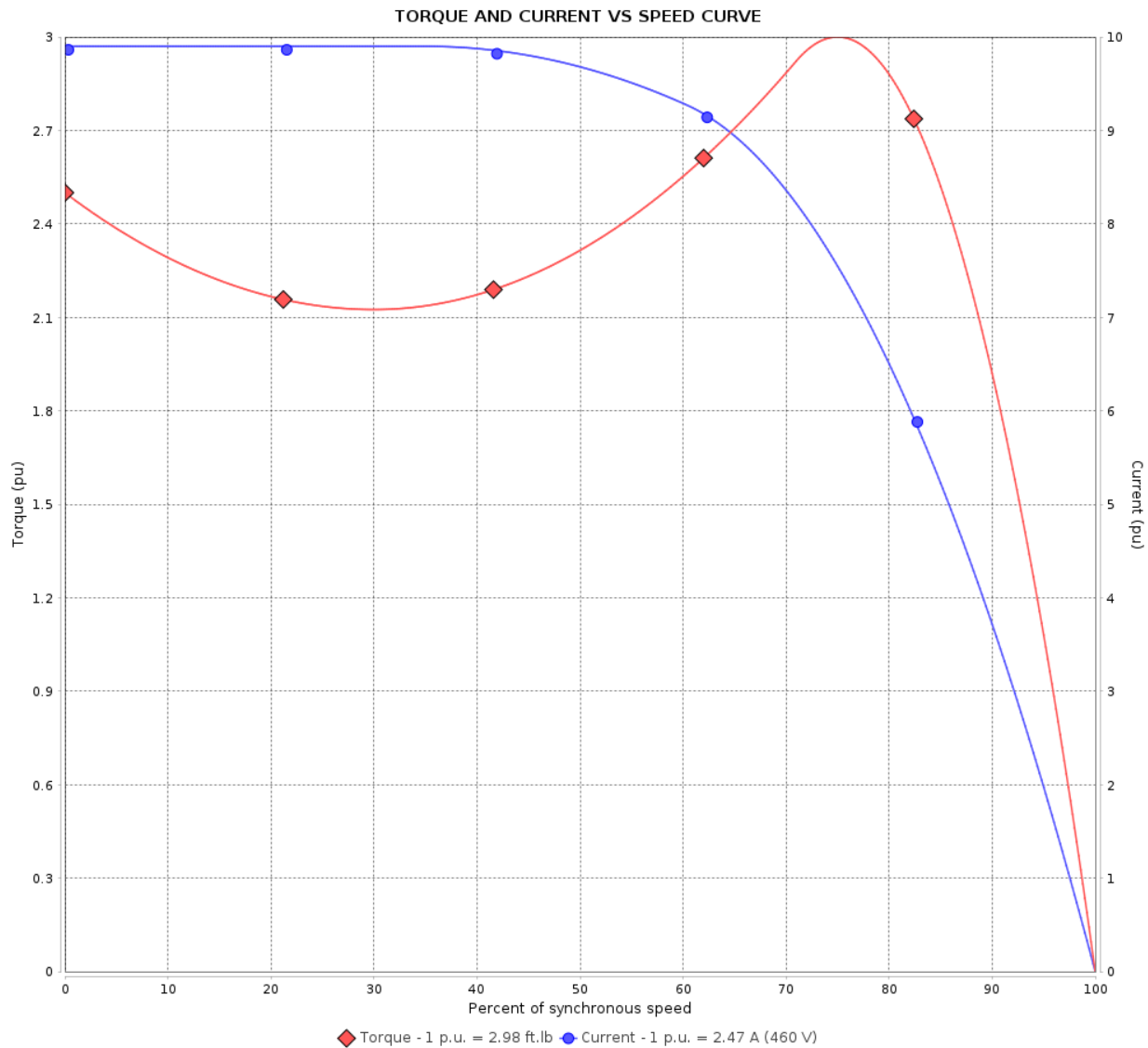

Performance : 230/460 V 60 Hz 2P

Rated current	: 4.94/2.47 A	Moment of inertia (J)	: 0.1279 sq.ft.lb
LRC	: 9.9	Duty cycle	: Cont.(S1)
Rated torque	: 2.98 ft.lb	Insulation class	: F
Locked rotor torque	: 250 %	Service factor	:
Breakdown torque	: 300 %	Temperature rise	: 80 K
Rated speed	: 3520 rpm	Design	: B

Locked rotor time : 23s (cold) 13s (hot)

Rev.	Changes Summary	Performed	Checked	Date
Performed by			Page 2 / 16	Revision
Checked by				
Date	13/02/2023			

TORQUE AND CURRENT VS SPEED CURVE



Three Phase Induction Motor - Squirrel Cage

Customer :

Product line : Rolled Steel Jet Pump - J type Premium
Efficiency Three-Phase

Product code : 13521998

Catalog # : 00236ET3EJP56J-S

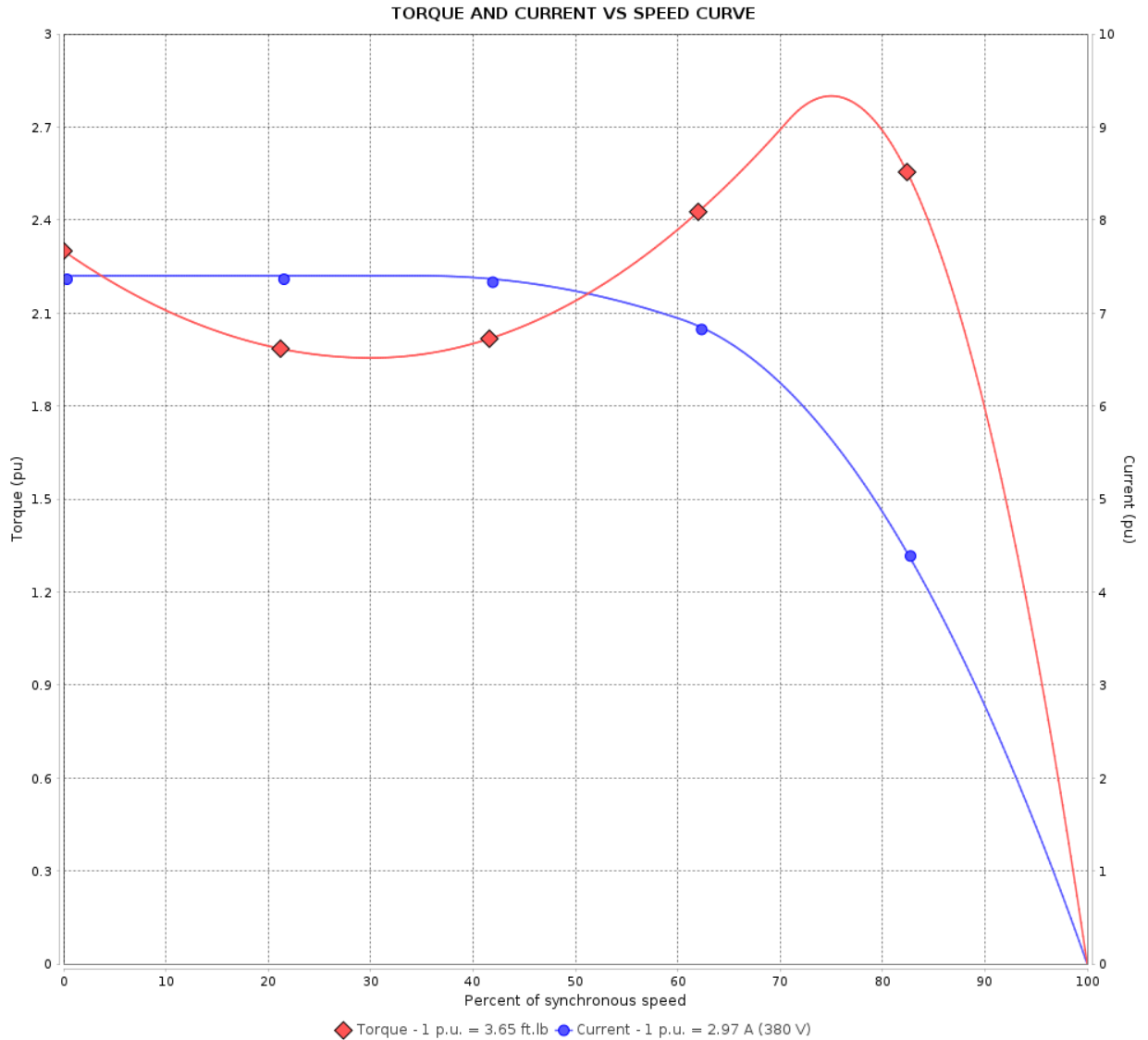

Performance : 190-220/380 V 50 Hz 2P

Rated current	: 5.94-5.13/2.97 A	Moment of inertia (J)	: 0.1279 sq.ft.lb
LRC	: 7.4	Duty cycle	: Cont.(S1)
Rated torque	: 3.65 ft.lb	Insulation class	: F
Locked rotor torque	: 229 %	Service factor	: 1.15
Breakdown torque	: 280 %	Temperature rise	: 80 K
Rated speed	: 2875 rpm	Design	: B

Locked rotor time : 21s (cold) 12s (hot)

Rev.	Changes Summary	Performed	Checked	Date
Performed by			Page 3 / 16	Revision
Checked by				
Date	13/02/2023			

TORQUE AND CURRENT VS SPEED CURVE

Three Phase Induction Motor - Squirrel Cage



Customer :

Product line : Rolled Steel Jet Pump - J type Premium
Efficiency Three-Phase

Product code : 13521998

Catalog # : 00236ET3EJP56J-S

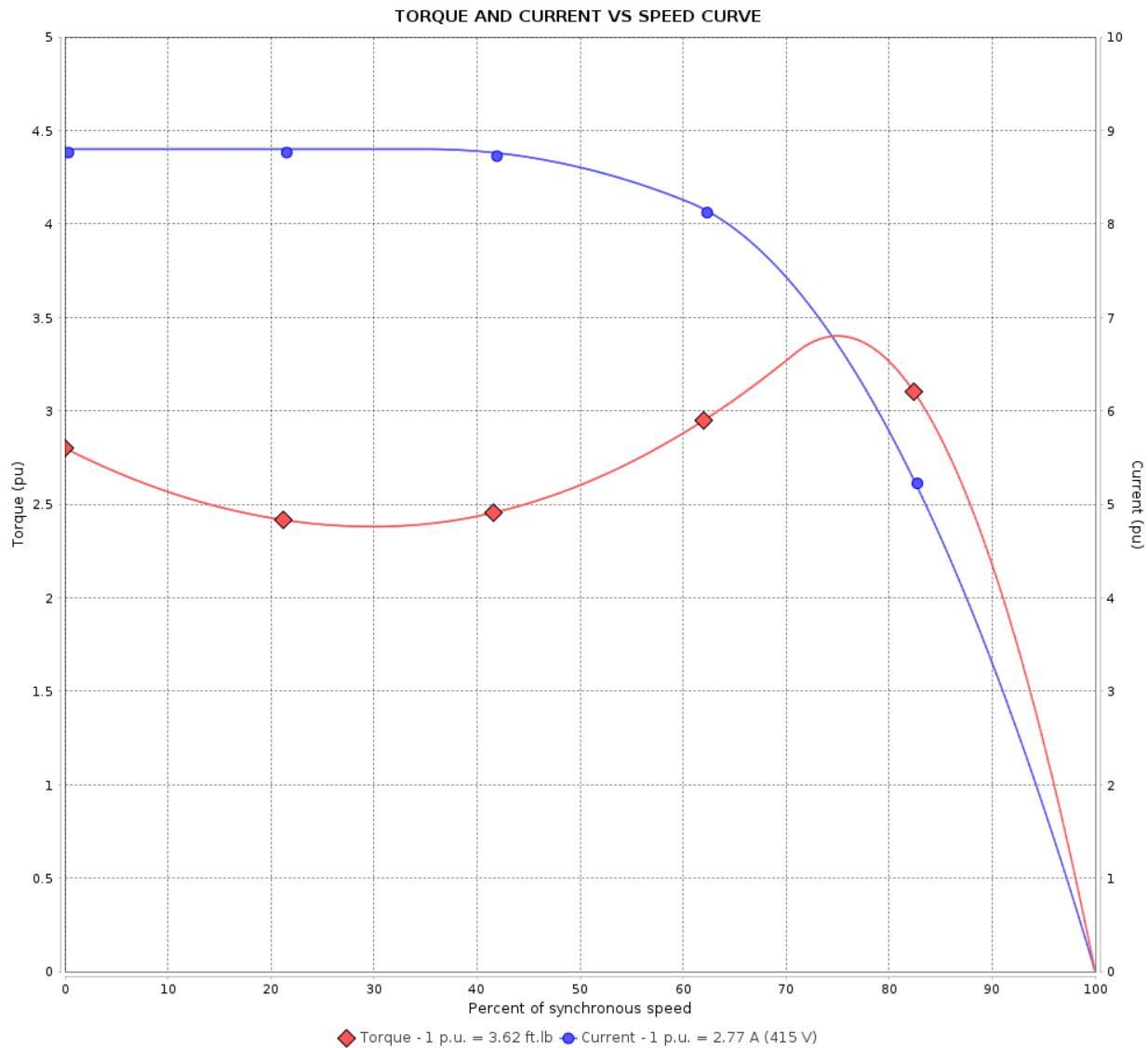

Performance : 415 V 50 Hz 2P

Rated current	: 2.77 A	Moment of inertia (J)	: 0.1279 sq.ft.lb
LRC	: 8.8	Duty cycle	: Cont.(S1)
Rated torque	: 3.62 ft.lb	Insulation class	: F
Locked rotor torque	: 280 %	Service factor	: 1.15
Breakdown torque	: 340 %	Temperature rise	: 80 K
Rated speed	: 2900 rpm	Design	: B

Locked rotor time : 18s (cold) 10s (hot)

Rev.	Changes Summary	Performed	Checked	Date
Performed by			Page 4 / 16	Revision
Checked by				
Date	13/02/2023			

LOAD PERFORMANCE CURVE

Three Phase Induction Motor - Squirrel Cage



Customer :

Product line : Rolled Steel Jet Pump - J type Premium
Efficiency Three-Phase

Product code : 13521998

Catalog # : 00236ET3EJP56J-S

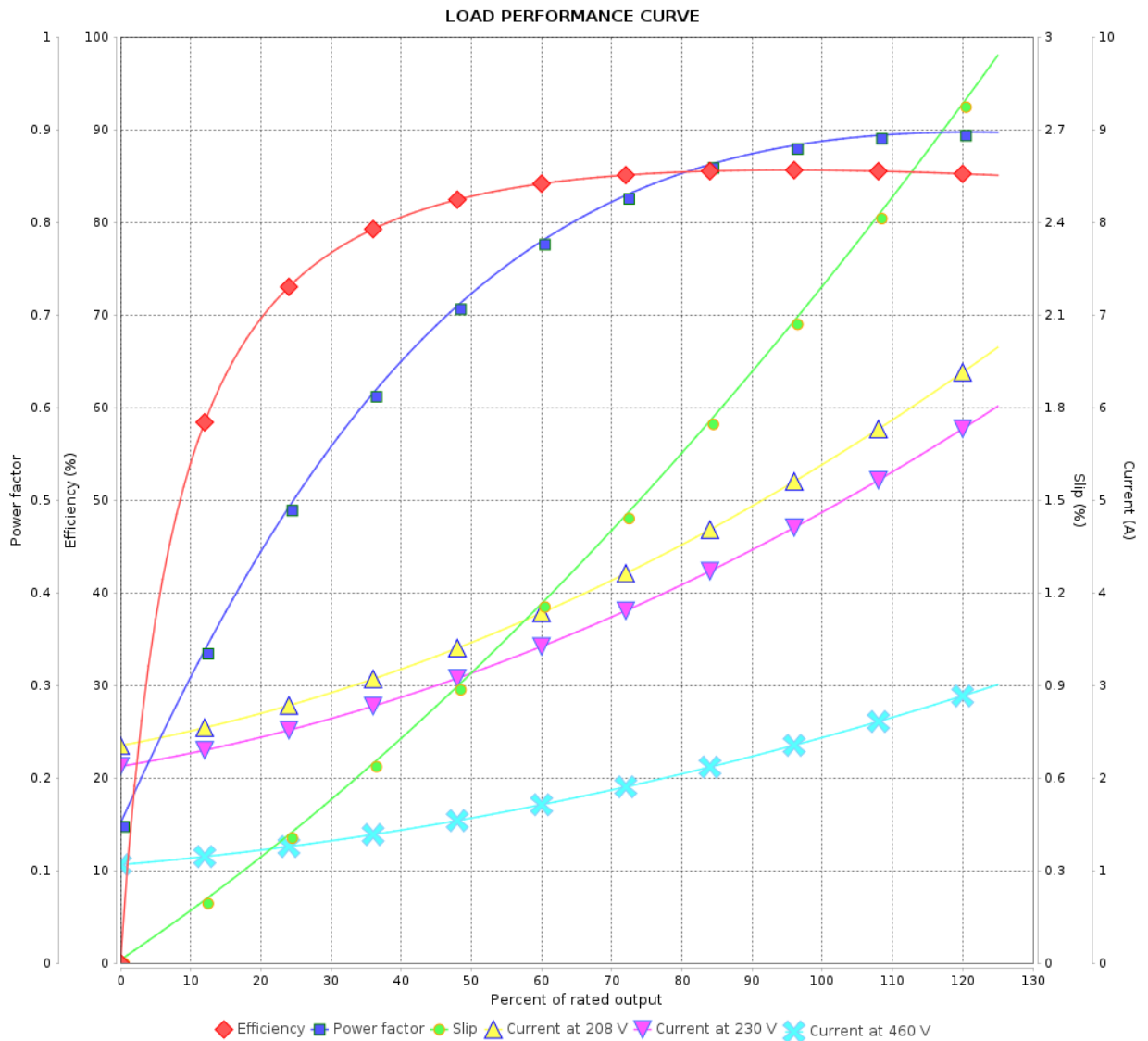

Performance : 230/460 V 60 Hz 2P

Rated current : 4.94/2.47 A
 LRC : 9.9
 Rated torque : 2.98 ft.lb
 Locked rotor torque : 250 %
 Breakdown torque : 300 %
 Rated speed : 3520 rpm

Moment of inertia (J) : 0.1279 sq.ft.lb
 Duty cycle : Cont.(S1)
 Insulation class : F
 Service factor :
 Temperature rise : 80 K
 Design : B

Rev.	Changes Summary	Performed	Checked	Date
Performed by				
Checked by			Page	Revision
Date	13/02/2023		5 / 16	

LOAD PERFORMANCE CURVE

Three Phase Induction Motor - Squirrel Cage



Customer :

Product line : Rolled Steel Jet Pump - J type Premium
Efficiency Three-Phase

Product code : 13521998

Catalog # : 00236ET3EJP56J-S

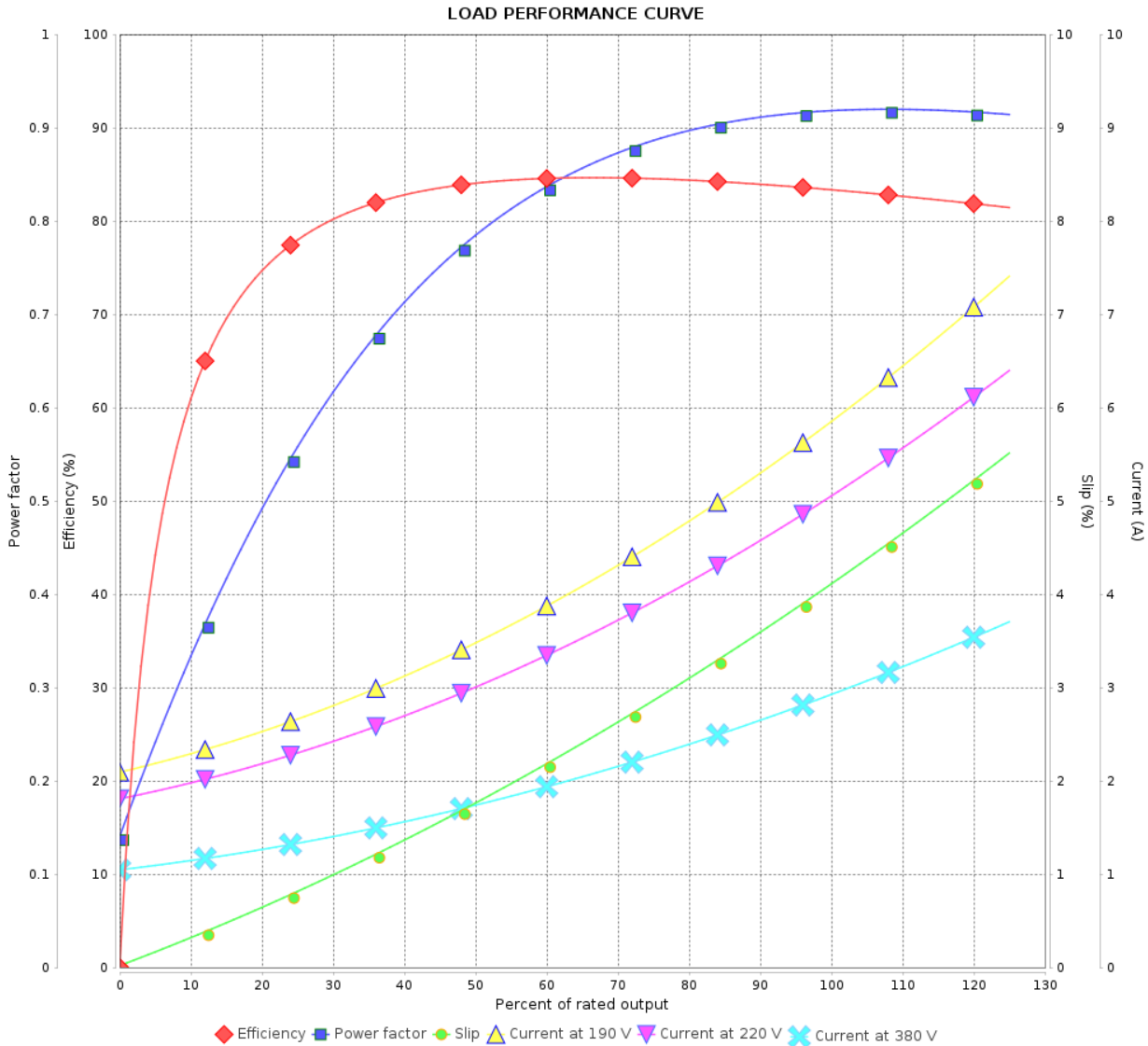

Performance : 190-220/380 V 50 Hz 2P

Rated current : 5.94-5.13/2.97 A
 LRC : 7.4
 Rated torque : 3.65 ft.lb
 Locked rotor torque : 229 %
 Breakdown torque : 280 %
 Rated speed : 2875 rpm

Moment of inertia (J) : 0.1279 sq.ft.lb
 Duty cycle : Cont.(S1)
 Insulation class : F
 Service factor : 1.15
 Temperature rise : 80 K
 Design : B

Rev.	Changes Summary	Performed	Checked	Date
Performed by			Page 6 / 16	Revision
Checked by				
Date	13/02/2023			

LOAD PERFORMANCE CURVE

Three Phase Induction Motor - Squirrel Cage



Customer : _____

Product line : Rolled Steel Jet Pump - J type Premium
Efficiency Three-Phase

Product code : 13521998

Catalog # : 00236ET3EJP56J-S

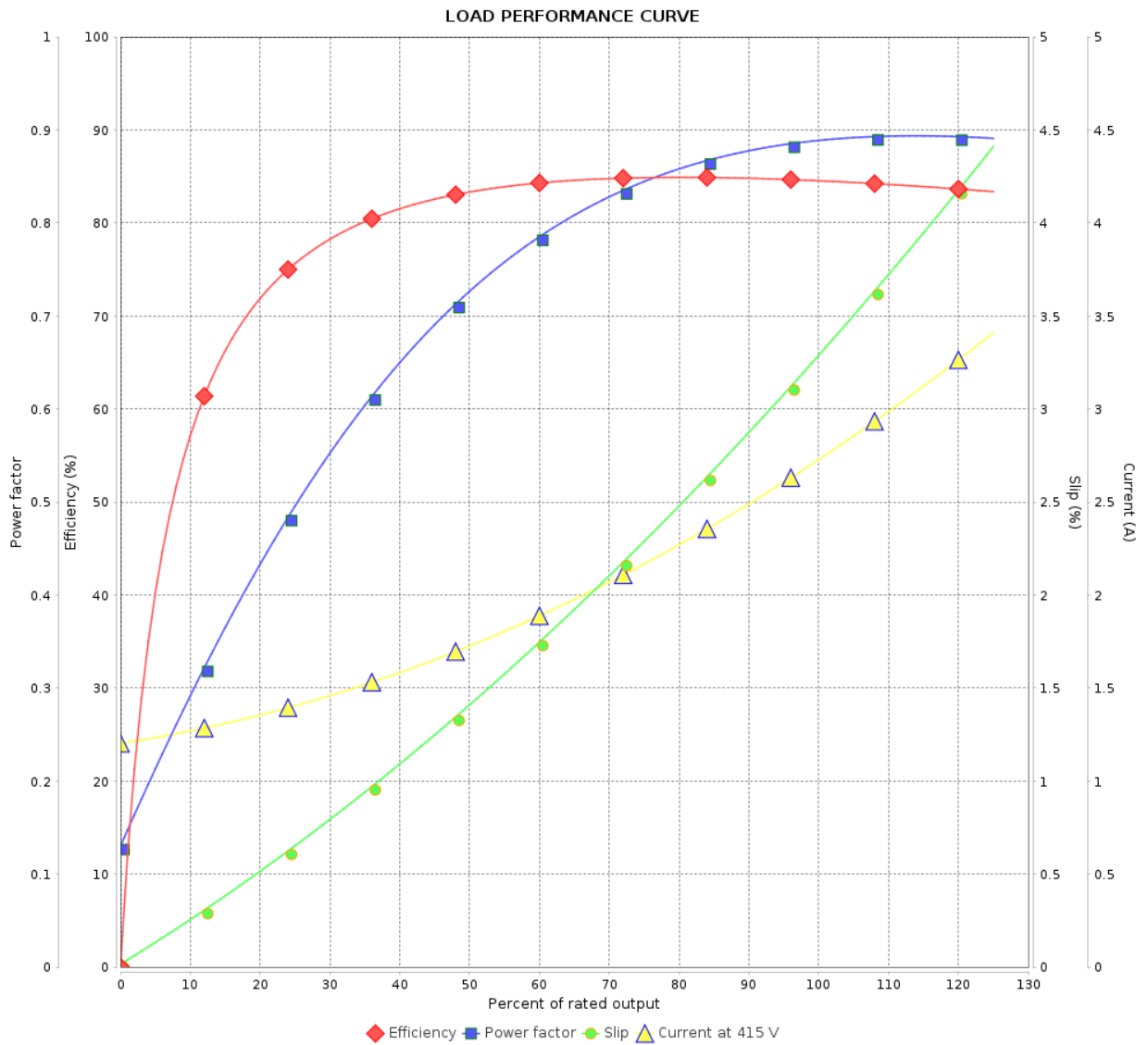

Performance : 415 V 50 Hz 2P

Rated current : 2.77 A
 LRC : 8.8
 Rated torque : 3.62 ft.lb
 Locked rotor torque : 280 %
 Breakdown torque : 340 %
 Rated speed : 2900 rpm

Moment of inertia (J) : 0.1279 sq.ft.lb
 Duty cycle : Cont.(S1)
 Insulation class : F
 Service factor : 1.15
 Temperature rise : 80 K
 Design : B

Rev.	Changes Summary	Performed	Checked	Date
Performed by		Page		Revision
Checked by		7 / 16		
Date		13/02/2023		

THERMAL LIMIT CURVE



Three Phase Induction Motor - Squirrel Cage

Customer :

Product line : Rolled Steel Jet Pump - J type Premium
Efficiency Three-Phase

Product code : 13521998

Catalog # : 00236ET3EJP56J-S

Performance : 230/460 V 60 Hz 2P

Rated current : 4.94/2.47 A
LRC : 9.9
Rated torque : 2.98 ft.lb
Locked rotor torque : 250 %
Breakdown torque : 300 %
Rated speed : 3520 rpm

Moment of inertia (J) : 0.1279 sq.ft.lb
Duty cycle : Cont.(S1)
Insulation class : F
Service factor :
Temperature rise : 80 K
Design : B

Heating constant

Cooling constant

Rev.	Changes Summary	Performed	Checked	Date
Performed by				
Checked by			Page	Revision
Date	13/02/2023		8 / 16	

THERMAL LIMIT CURVE

Three Phase Induction Motor - Squirrel Cage



Customer : _____

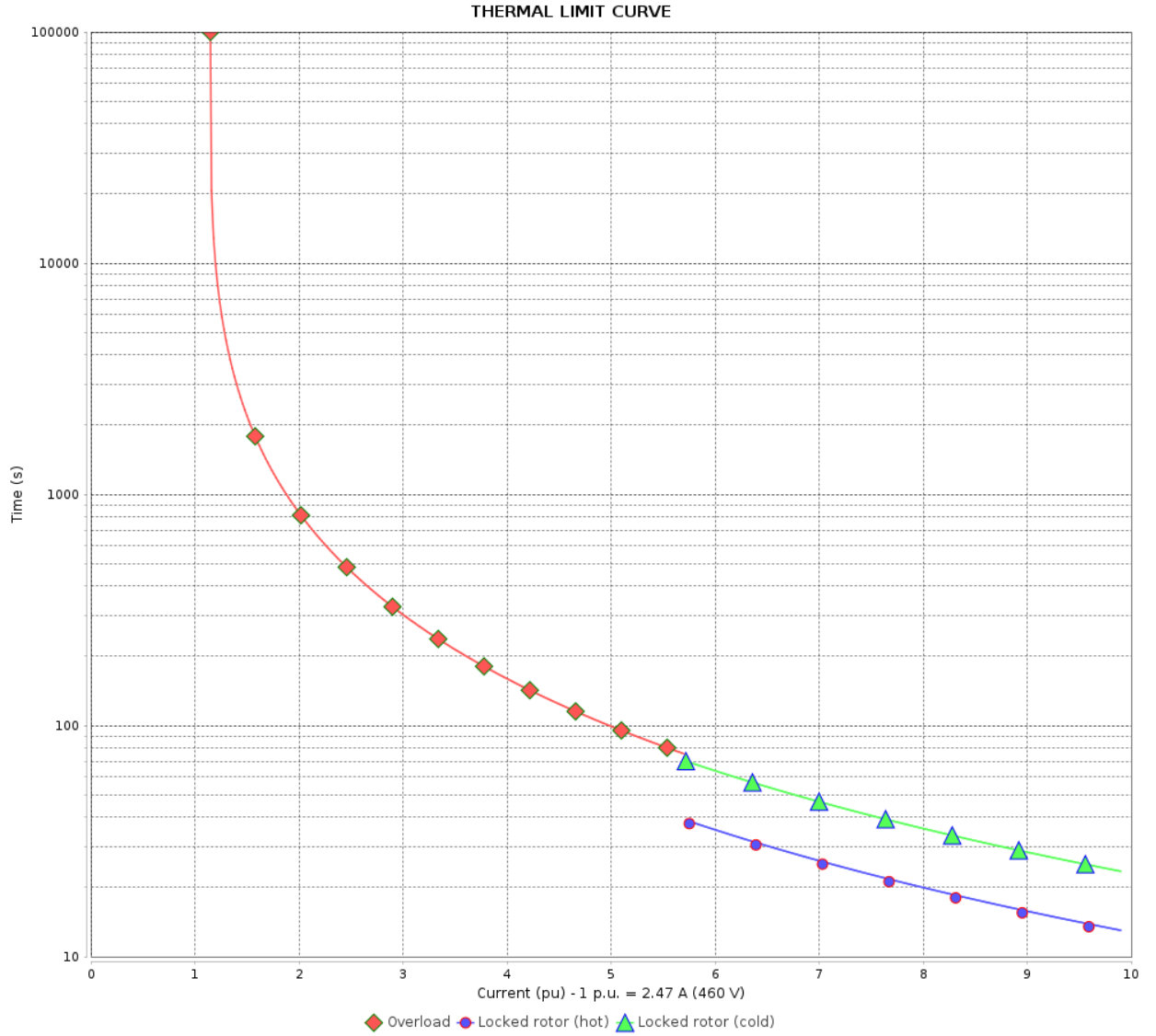

Rev.	Changes Summary	Performed	Checked	Date
Performed by		Page		Revision
Checked by		9 / 16		
Date		13/02/2023		

THERMAL LIMIT CURVE



Three Phase Induction Motor - Squirrel Cage

Customer :

Product line : Rolled Steel Jet Pump - J type Premium
Efficiency Three-Phase

Product code : 13521998

Catalog # : 00236ET3EJP56J-S

Performance : 190-220/380 V 50 Hz 2P

Rated current : 5.94-5.13/2.97 A
LRC : 7.4
Rated torque : 3.65 ft.lb
Locked rotor torque : 229 %
Breakdown torque : 280 %
Rated speed : 2875 rpm

Moment of inertia (J) : 0.1279 sq.ft.lb
Duty cycle : Cont.(S1)
Insulation class : F
Service factor : 1.15
Temperature rise : 80 K
Design : B

Heating constant

Cooling constant

Rev.	Changes Summary	Performed	Checked	Date
Performed by				
Checked by			Page	Revision
Date	13/02/2023		10 / 16	

THERMAL LIMIT CURVE

Three Phase Induction Motor - Squirrel Cage



Customer : _____

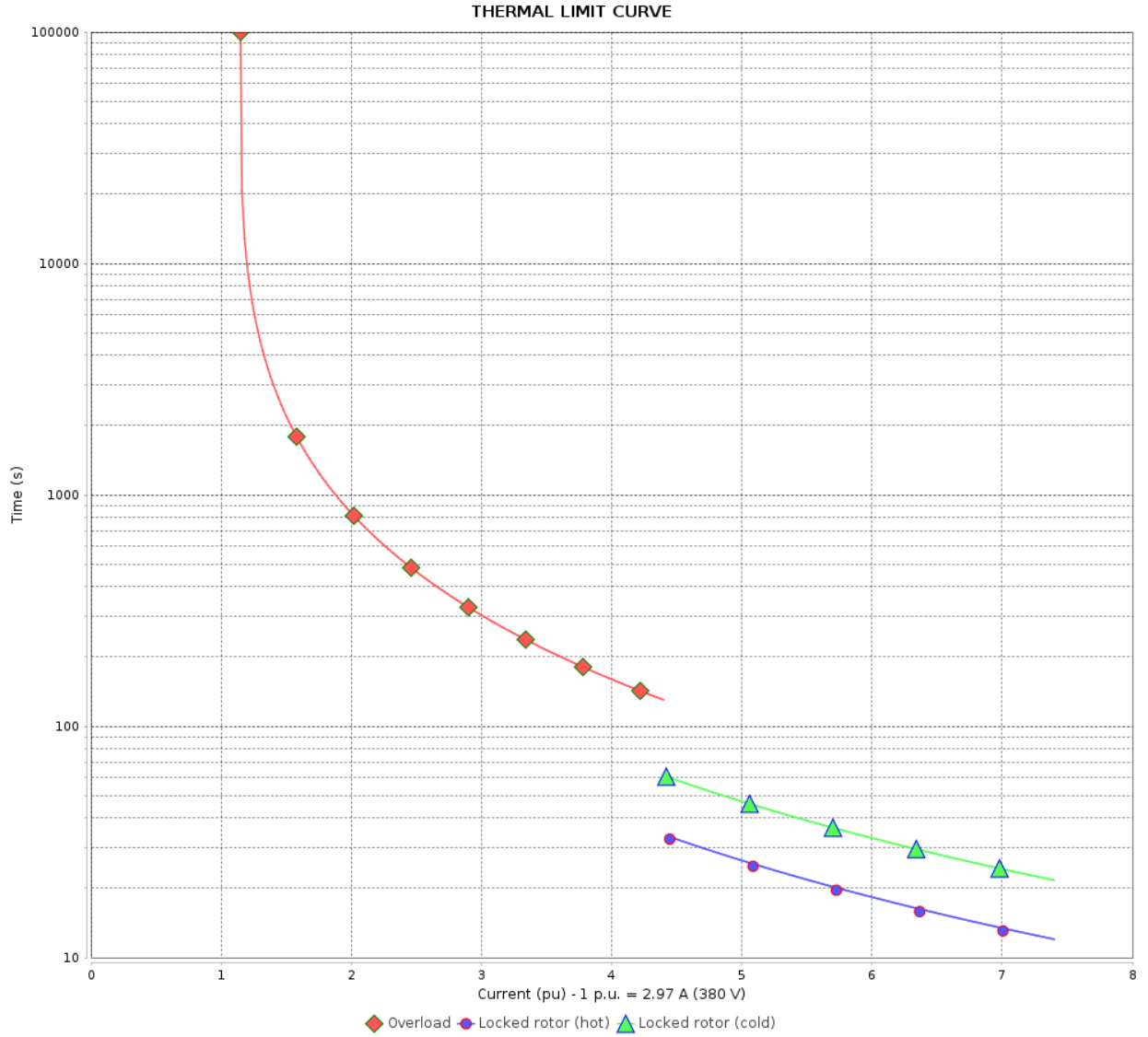

Rev.	Changes Summary	Performed	Checked	Date
Performed by		Page		Revision
Checked by				
Date				

THERMAL LIMIT CURVE



Three Phase Induction Motor - Squirrel Cage

Customer :

Product line : Rolled Steel Jet Pump - J type Premium
Efficiency Three-Phase

Product code : 13521998

Catalog # : 00236ET3EJP56J-S

Performance : 415 V 50 Hz 2P

Rated current : 2.77 A
LRC : 8.8
Rated torque : 3.62 ft.lb
Locked rotor torque : 280 %
Breakdown torque : 340 %
Rated speed : 2900 rpm

Moment of inertia (J) : 0.1279 sq.ft.lb
Duty cycle : Cont.(S1)
Insulation class : F
Service factor : 1.15
Temperature rise : 80 K
Design : B

Heating constant

Cooling constant

Rev.	Changes Summary	Performed	Checked	Date
Performed by				
Checked by			Page	Revision
Date	13/02/2023		12 / 16	

THERMAL LIMIT CURVE

Three Phase Induction Motor - Squirrel Cage



Customer : _____

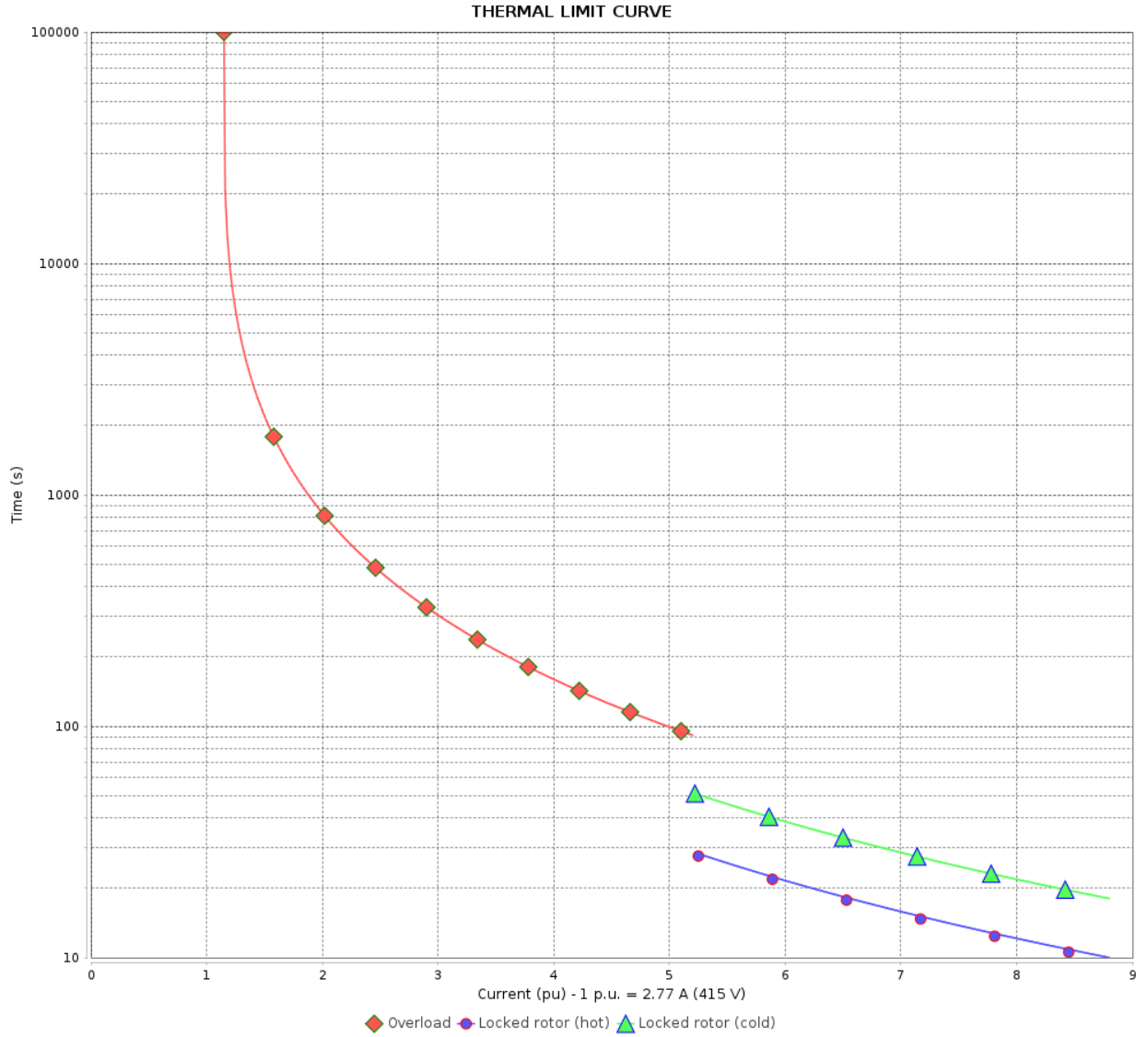

Rev.	Changes Summary	Performed	Checked	Date
Performed by		Page		Revision
Checked by		13 / 16		
Date		13/02/2023		

VFD OPERATION CURVE

Three Phase Induction Motor - Squirrel Cage



Customer :

Product line : Rolled Steel Jet Pump - J type Premium
Efficiency Three-Phase

Product code : 13521998

Catalog # : 00236ET3EJP56J-S

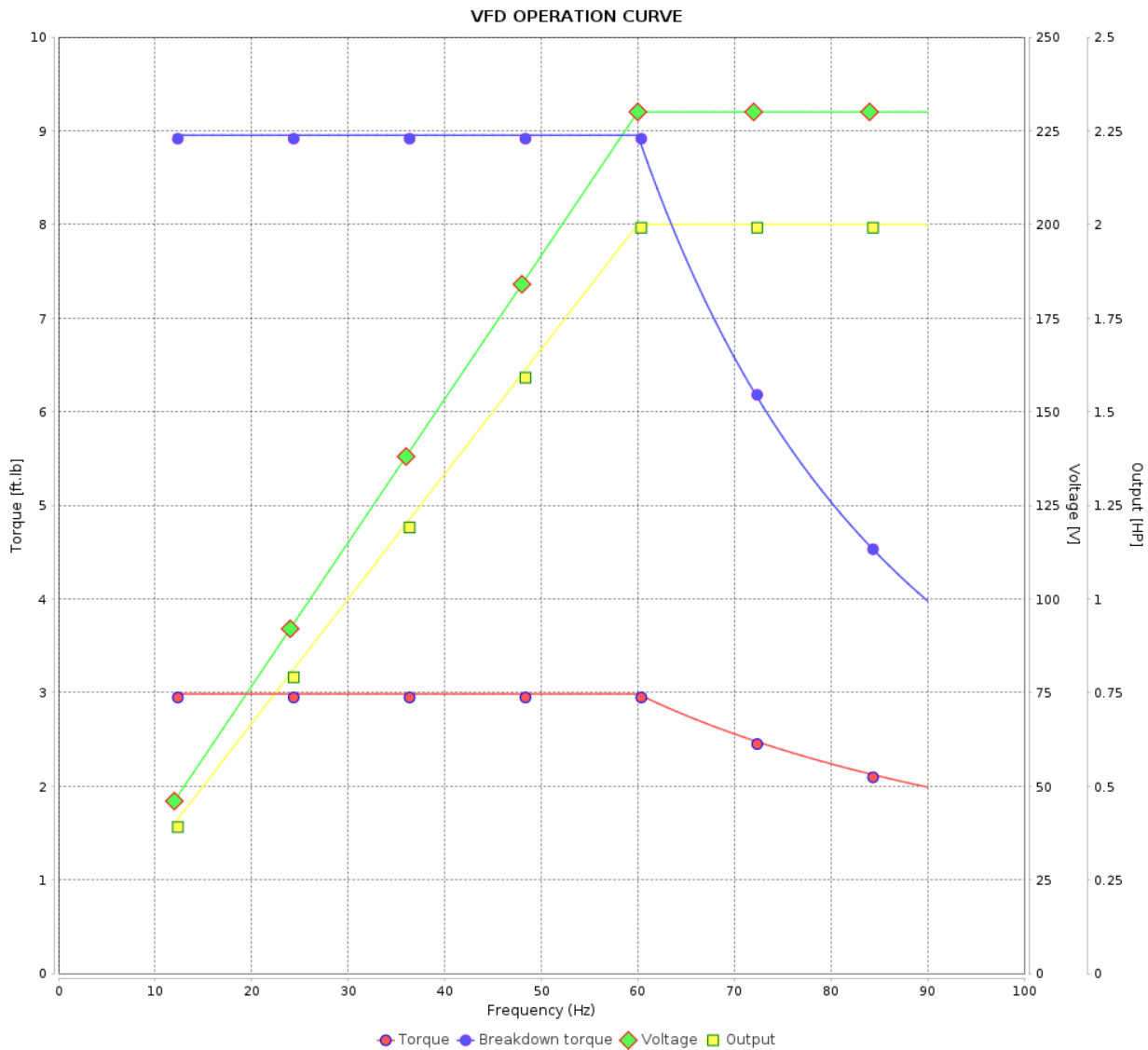

Performance : 230/460 V 60 Hz 2P

Rated current : 4.94/2.47 A
LRC : 9.9
Rated torque : 2.98 ft.lb
Locked rotor torque : 250 %
Breakdown torque : 300 %
Rated speed : 3520 rpm

Moment of inertia (J) : 0.1279 sq.ft.lb
Duty cycle : Cont.(S1)
Insulation class : F
Service factor :
Temperature rise : 80 K
Design : B

Rev.	Changes Summary	Performed	Checked	Date
Performed by			Page 14 / 16	Revision
Checked by				
Date	13/02/2023			

VFD OPERATION CURVE

Three Phase Induction Motor - Squirrel Cage



Customer :

Product line : Rolled Steel Jet Pump - J type Premium
Efficiency Three-Phase

Product code : 13521998

Catalog # : 00236ET3EJP56J-S

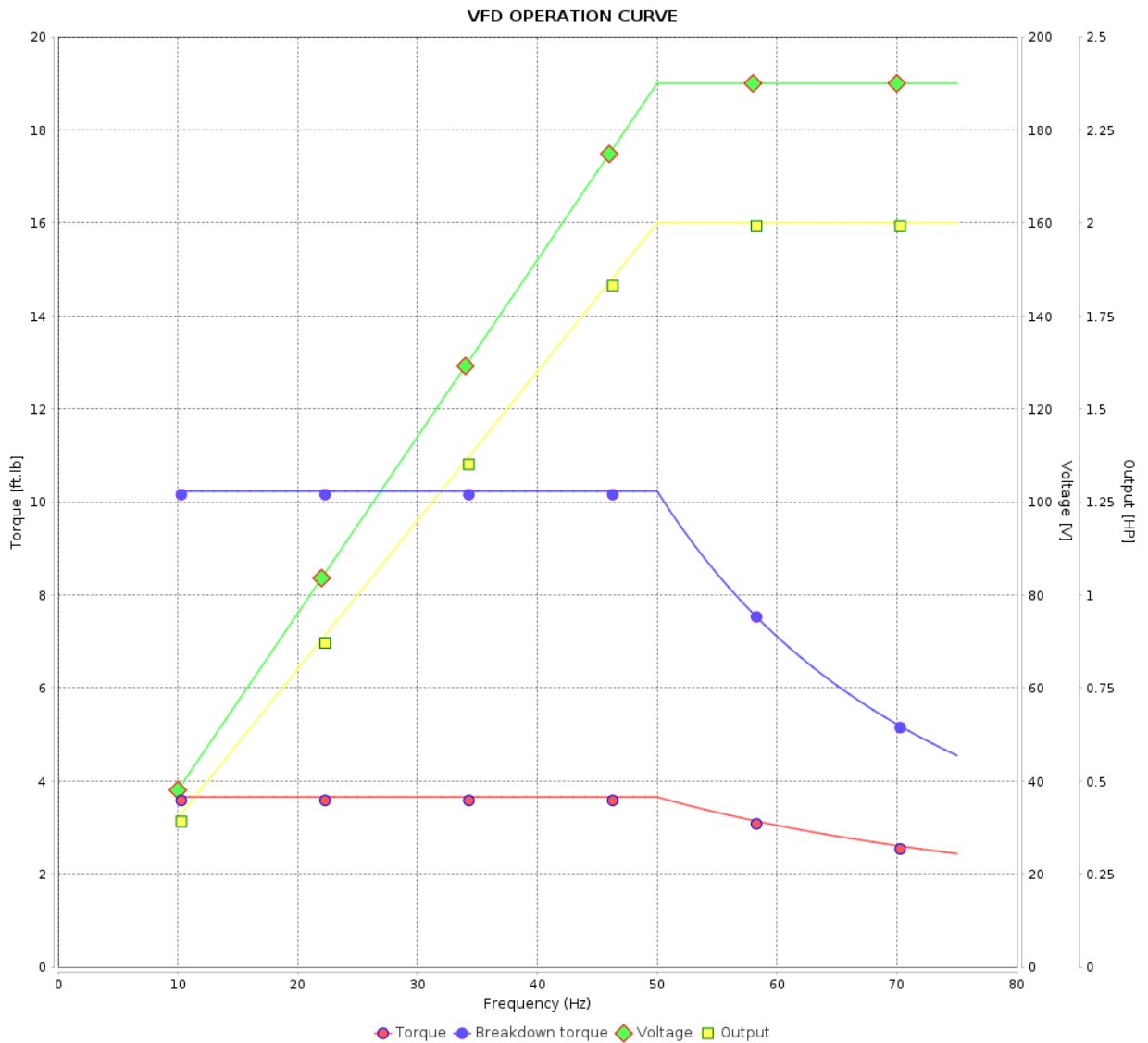

Performance : 190-220/380 V 50 Hz 2P

Rated current : 5.94-5.13/2.97 A
 LRC : 7.4
 Rated torque : 3.65 ft.lb
 Locked rotor torque : 229 %
 Breakdown torque : 280 %
 Rated speed : 2875 rpm

Moment of inertia (J) : 0.1279 sq.ft.lb
 Duty cycle : Cont.(S1)
 Insulation class : F
 Service factor : 1.15
 Temperature rise : 80 K
 Design : B

Rev.	Changes Summary	Performed	Checked	Date
Performed by			Page 15 / 16	Revision
Checked by				
Date	13/02/2023			

VFD OPERATION CURVE

Three Phase Induction Motor - Squirrel Cage



Customer :

Product line : Rolled Steel Jet Pump - J type Premium
Efficiency Three-Phase

Product code : 13521998

Catalog # : 00236ET3EJP56J-S

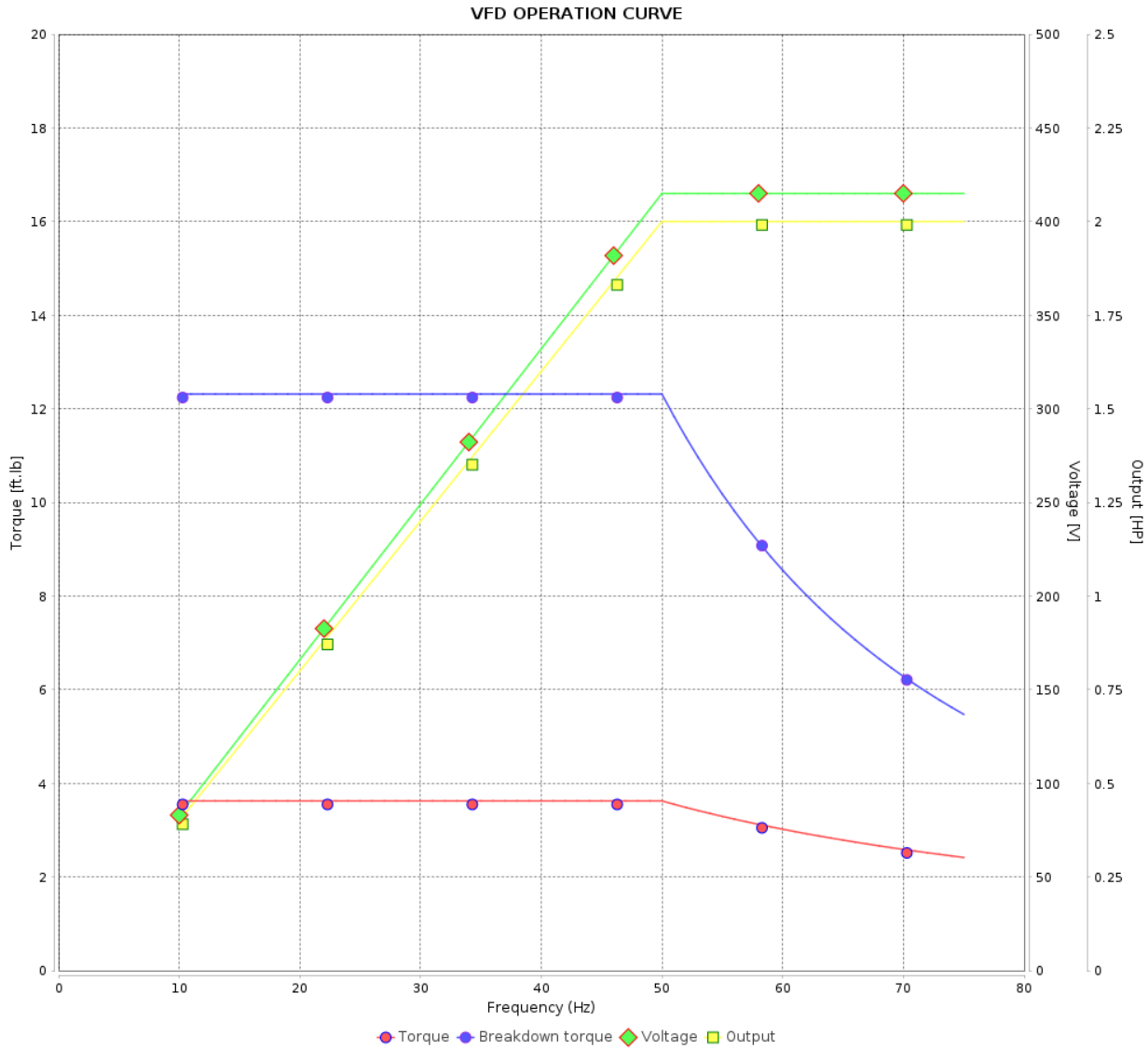

Performance : 415 V 50 Hz 2P

Rated current : 2.77 A
LRC : 8.8
Rated torque : 3.62 ft.lb
Locked rotor torque : 280 %
Breakdown torque : 340 %
Rated speed : 2900 rpm

Moment of inertia (J) : 0.1279 sq.ft.lb
Duty cycle : Cont.(S1)
Insulation class : F
Service factor : 1.15
Temperature rise : 80 K
Design : B

Rev.	Changes Summary	Performed	Checked	Date
Performed by			Page	Revision
Checked by				
Date				

1 2 3 4 5 6

A

B

C

D

E

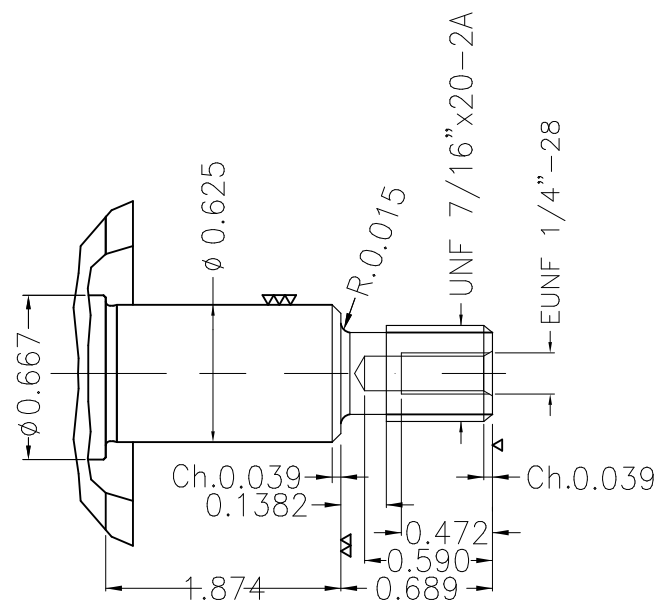
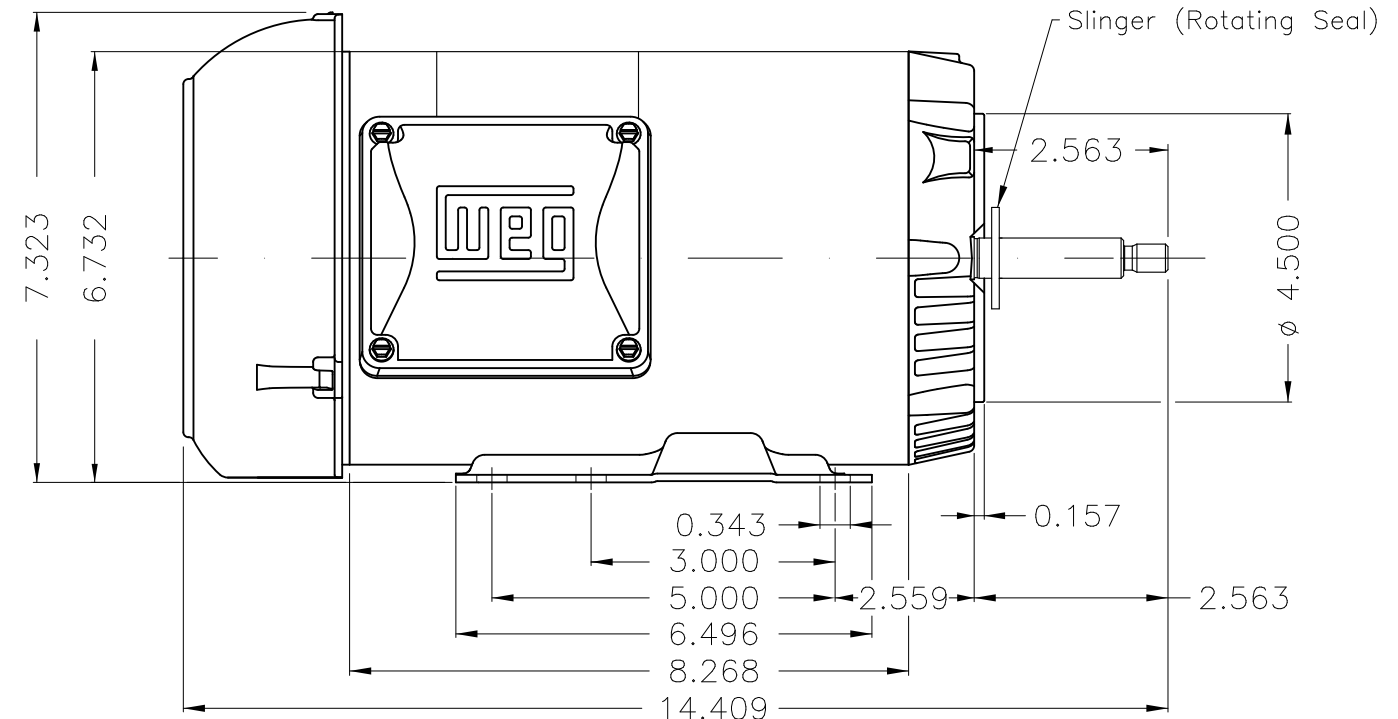
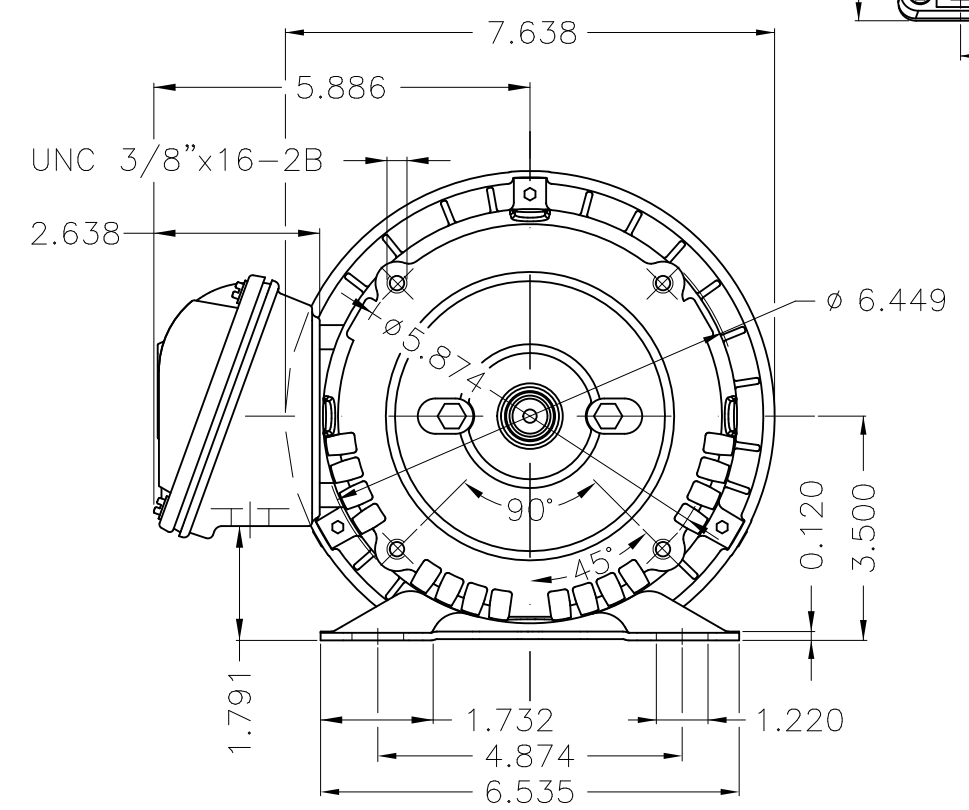
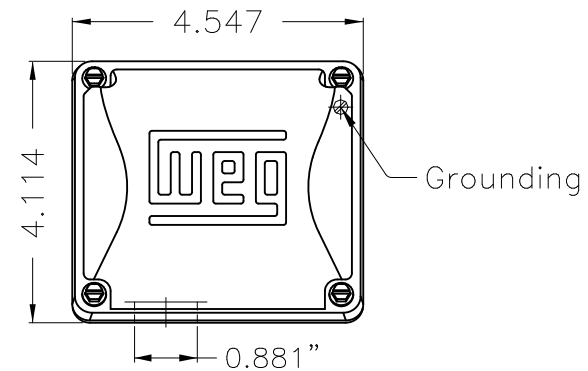

Color Munsell N 1 matte black
 Painting plan 207N
 Mounting F-1/B34R(D)

						HYBRISUSER								00	
ECM	LOC	SUMMARY OF MODIFICATIONS				EXECUTED	CHECKED	RELEASED	DATE	VER					
EXECUTED	HYBRISUSER	THREE PH. MOTOR ROLLED STEEL JET PUMP THREADED PUMP				EXECUTED	CHECKED	RELEASED	DATE	VER					
CHECKED		FRAME 56HJ IP55 TEFC				EXECUTED	CHECKED	RELEASED	DATE	VER					
RELEASED						EXECUTED	CHECKED	RELEASED	DATE	VER					
REL. DATE		WMO	Jaragua do Sul	Product Engineering	WDD	00	SHEET		1 / 1						

2 HP 02 Poles 60 Hz

A WMO Jaragua do Sul Product Engineering SHEET 1 / 1

WEG's property. Forbidden reproduction without previous authorization.



Dimensions in inches XME A3



NEMA
Premium



MADE IN MEXICO

MAT: 13521998 CC029A
W01.TE0IC0X0X
MODEL 00236ET3EJP56J-S

For 60Hz: Class I, Zone 2, IIC
Class I, Div.2, Gr. A,B,C,D - T3
Div 2 Inverter Duty (SF1.00)
CT 2:1/VT 1000:1

PH 3	Hz 60	HP 2.0
FR 56HJ		KW 1.5
DUTY CONT.		V 230/460
ALT 1000 m.a.s.l.		A 4.94/2.47
INS CL F AT 80K	IP55	SFA 5.68/2.84
AMB 40°C	DES B	SF 1.15
ENCL TEFC	CODE L	PF 0.89
USABLE @ 208V 5.46A		RPM 3520
SF1.00		NEMA NOM. EFF 85.5%

ALTERNATE RATING: 2.0HP 50Hz 190-220/380-415V SF1.15
5.94-5.23/2.97-2.77A 2875RPM EFF 83.3% (IE2) IEC 60034-1

DE 6203-2RS	ODE 6202-2RS	MOBIL POLYREX EM
-------------	--------------	------------------

For safe area-inverter duty motor For 60Hz use on VPWM 1000:1 VT, 5:1 CT



T1-BLU T2-WHT
T3-ORG T4-YEL
T5-BLK T6-GRY
T7-PNK T8-RED
T9-RED BRK



WARNING: Motor must be grounded in accordance with local and national electrical codes to prevent serious electrical shocks. Disconnect power source before servicing unit.

AVERTISSEMENT: Le moteur doit être mis à la terre conformément aux codes électriques locaux et nationaux afin d'éviter tout choc électrique grave. Déconnectez l'alimentation avant l'entretien de la machine.

