

# Reflector

## Dimensions (in mm)

**K-7**

CAD

Applicable to polarization reflector type  
 Effective reflecting surface: 56 x 36 mm  
 Material: Mirror: acrylic / Base: heat-resistant ABS  
 Protective structure: IP 67  
 Mounting: secured with M3 screws (alternatively adhesive may be used)

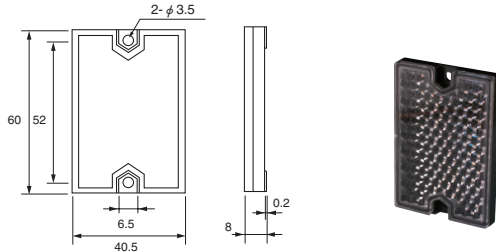

**S-15**

CAD

Effective reflecting surface:  $\phi$  15  
 Mounting: Pasted: adhesive on back side



**K-71**

CAD

Applicable to polarization reflector type  
 Effective reflecting surface: 32 x 19 mm  
 Mounting: mounting bracket provided, secured with M3 screws (alternatively adhesive may be used)

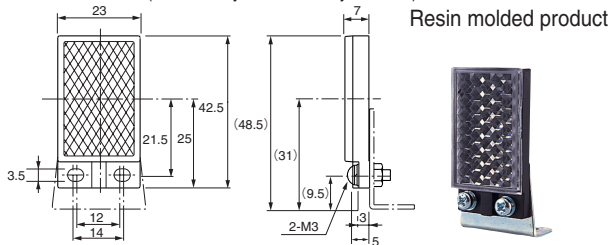

**S-15B**

CAD

Effective reflecting surface:  $\phi$  15  
 Mounting: Secured by pasting or with M3 screws

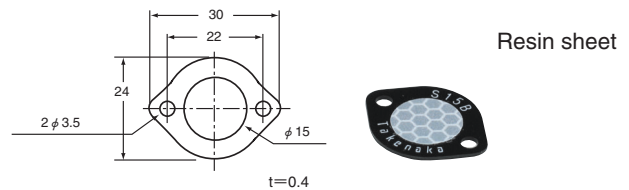

**K-77**

Applicable to polarization reflector type  
 Effective reflecting surface: 68 x 56 mm  
 Mounting: secured with M3 screws (alternatively adhesive may be used)

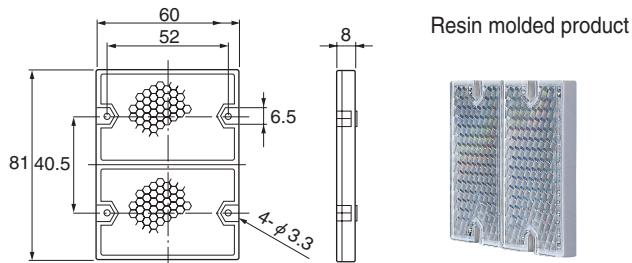

**S-25**

Effective reflecting surface:  $\phi$  18.5 mm x 25 per sheet  
 Mounting: Pasted: adhesive on back side

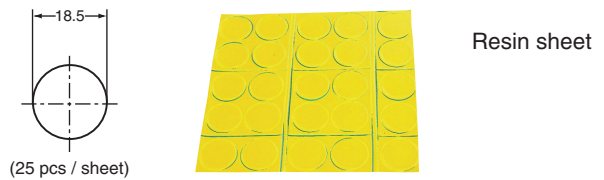

**K-72**

Applicable to polarization reflector type  
 Effective reflecting surface: 29 x 8 mm  
 Material: Mirror: acrylic / Base: heat-resistant ABS  
 Protective structure: IP 67  
 Mounting: mounting bracket provided, secured with M3 screws

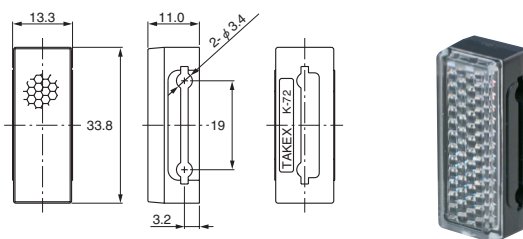

**S-100**  
**S-200**

Effective reflecting surface: 100mm x 100mm (S-100)  
 Mounting: Pasted: adhesive on back side

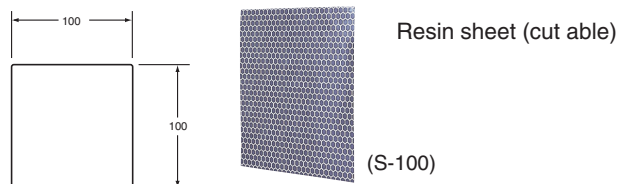

**S-520**  
**S-310-S**

Applicable to polarization reflector type  
 (S-520) Effective reflecting surface: 198 x 48 mm / Color: yellow  
 (S-310-S) Effective reflecting surface: 98 x 28 mm / Color: Silver  
 Mounting: Pasted: adhesive on back side

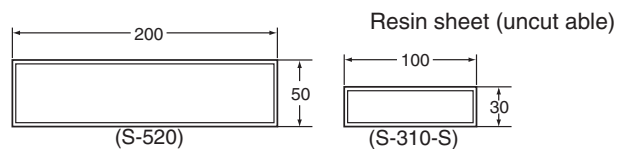

**K-MT4**

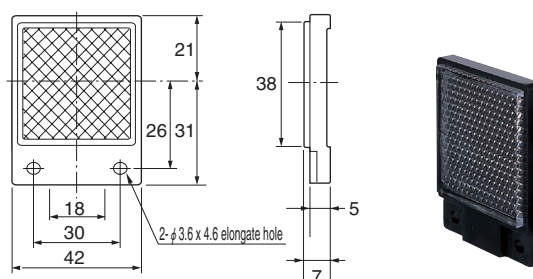

**S-510G**

Applicable to polarization reflector type  
 Effective reflecting surface: 100 x 50mm  
 Mounting: Pasted: adhesive on back side

