



EN Operating instructions.pages 1 to 2
Original

Product description

Ordering code
This operating instructions manual applies to the following types:

NBGLC①②.③④		
No.	Option	Description
①		Enclosure size
②		Number of drilled holes for command devices
③		Position of the cable gland
	1	Side, bottom
	2	Side, top
	3	In the floor
④	/NSK	with protective collar

Special versions
For special versions, which are not listed in the order code, these specifications apply accordingly, provided that they correspond to the standard version.

Dimensions

All measurements in mm.

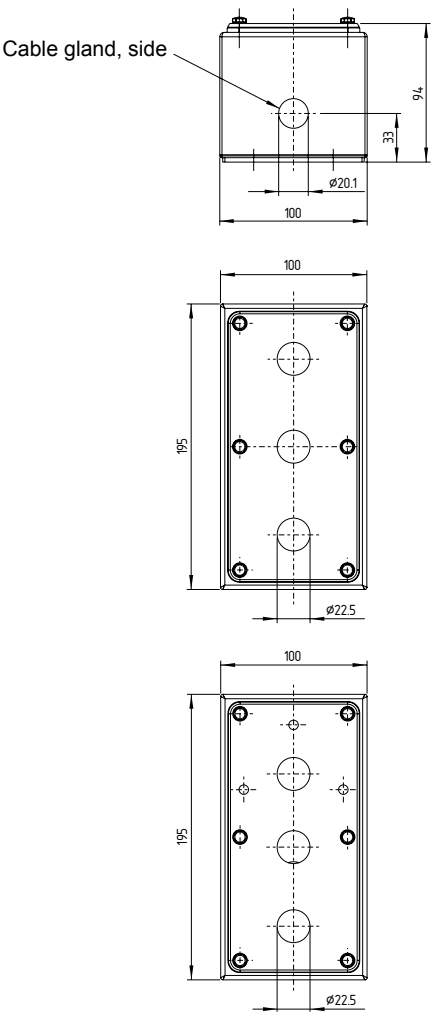

Special version for NSK protective collar

i Tightening torque of the fixing screws, guard collar
NSK 1 Nm ± 0.1 Nm

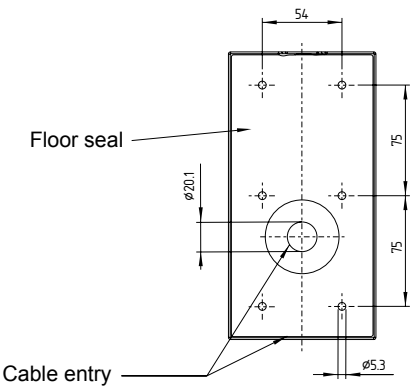

i The cable entry in the enclosure floor is standard. Devices with the addition .1 or .2 in the type designation have side cable entry instead of floor entry (.3).

Mounting



In hygiene-sensitive applications, the assembly housing must be fitted with an offset angle of at least 3° in order to ensure that water and other liquids can run off.



Assembly must be carried out on a grease-free, level surface with suitable M5 cheese-head screws and a sealing element to ensure a protection class up to IP69K. In hygiene applications, it must be ensured that cleaning and inspection for damage can be carried out from all sides. As such, we recommend a clearance of at least 10 cm to other machine parts.

Enclosure for surface mounting

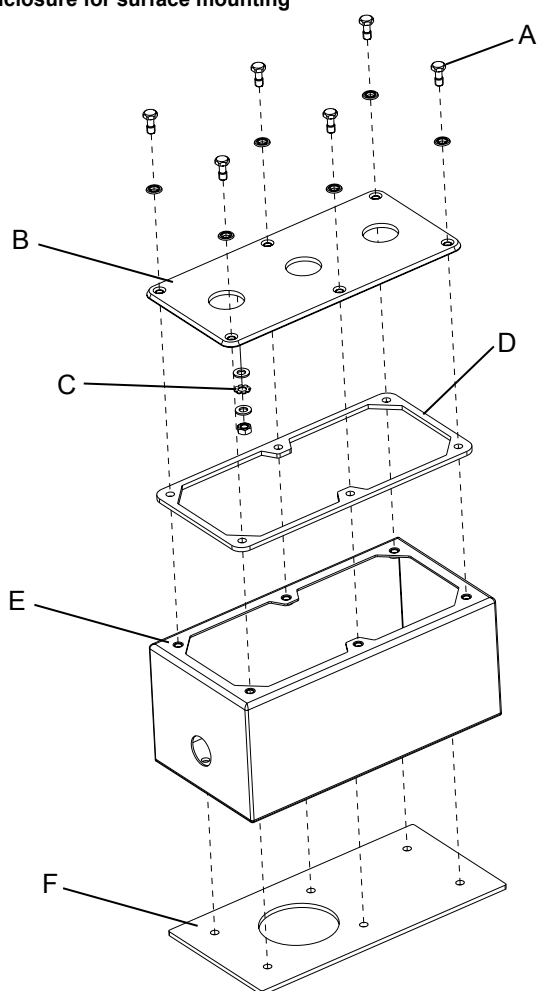

Tightening torque for the M5 fixing screws in the enclosure lower section 2 Nm ± 0.1 Nm.

Key

- A: Cover fixing screws with gasket
- B: Enclosure cover
- C: Earth connections
- D: Cover gasket
- E: Enclosure lower section
- F: Floor seal

Supply kit

A: Supply kit with 6x cover fixing screws with gasket

C: Earth connection supply kit comprising 6x washers, 3x serrated lock washers and 3x nuts

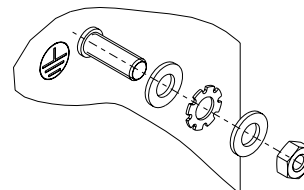
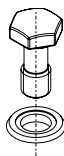

Tightening torque 1,3 Nm ± 0,1 Nm

Maintenance



Only approved cleaning agents are permitted for cleaning. We would be happy to provide a list on request. Cleaning must not be carried out above 80 °C. After cleaning, an inspection must be carried out from all sides to check for damage. Faulty devices/parts must be replaced immediately.

K. A. Schmersal GmbH & Co. KG
Möddinghofe 30, D - 42279 Wuppertal
Postfach 24 02 63, D - 42232 Wuppertal

Phone: +49 - (0)2 02 - 64 74 - 0
Telefax: +49 - (0)2 02 - 64 74 - 1 00
E-Mail: info@schmersal.com
Internet: <http://www.schmersal.com>

