

STAINLESS STEEL HMI ENCLOSURES

Application

Designed to house Human-Machine Interfaces (HMI) and electrical and electronic controls, instruments and components. Provides a degree of protection from dust, oil and water.

Construction

- 0.075" stainless steel Type 304.
- Seams continuously welded and ground smooth.
- Reinforced with mounting provisions for suspension or pedestal mounting.
- Concealed hinge access door with provisions for sub-panel.
- Removable front cover for easy installation of cutouts, HMI and components.
- Pour in place oil and water resistant gasket
- Black quarter turn latches.
- Latches are opened or closed with a screwdriver.
- Ground studs on door and body.

Finish

#4 brushed finish on all exterior surfaces. Optional sub-panels powder coated white..

Options

- Tamper-resistant latches
- Pull handles
- Keyboard Shelf

IS6 Industry Standards

NEMA Type 3R, 4, 4X, 12 & Type 13
 UL Listed Type 3R, 4, 4X & 12
 CA Type 4, 4X & 12
 IEC 60529 IP66

***To maintain Type 3R listing, Drainage is required. Install equally rated drainage device or drill a 1/8 to 1/4 inch hole in the bottom center of the enclosure, approximately 1 inch from the right, and 1 inch from the left for drainage, use listed rain-tight or wet location hubs. Drip shield over the door is recommended for all outdoor applications.

Enclosure Product Code C2

Sub-Panel (P3)

Catalog No.	Height (A)	Width (B)	Depth (C)	Industry Standard	Catalog No.	Panel Height (D)	Panel Width (E)
SCE-12HMI1606SSLP	12.00	16.00	6.00	IS6	SCE-12P10	11.00	9.00
SCE-12HMI1610SSLP	12.00	16.00	10.00	IS6	SCE-12P10	11.00	9.00
SCE-14HMI1806SSLP	14.00	18.00	6.00	IS6	SCE-14P12	13.00	11.00
SCE-14HMI1810SSLP	14.00	18.00	10.00	IS6	SCE-14P12	13.00	11.00
SCE-16HMI2006SSLP	16.00	20.00	6.00	IS6	SCE-16P14	15.00	13.00
SCE-16HMI2010SSLP	16.00	20.00	10.00	IS6	SCE-16P14	15.00	13.00
SCE-20HMI2406SSLP	20.00	24.00	6.00	IS6	SCE-20P18HMI	19.00	17.00
SCE-20HMI2410SSLP	20.00	24.00	10.00	IS6	SCE-20P18HMI	19.00	17.00



STAINLESS STEEL HMI ENCLOSURES

TECHNICAL DATA

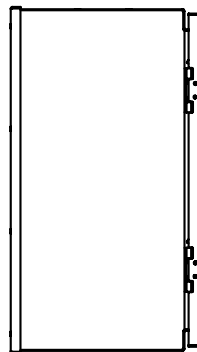
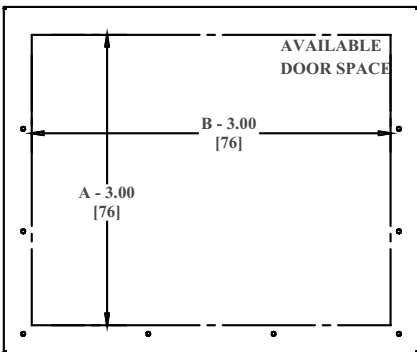
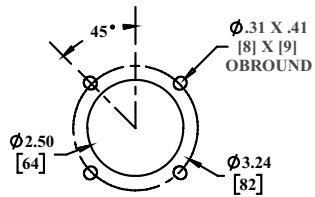
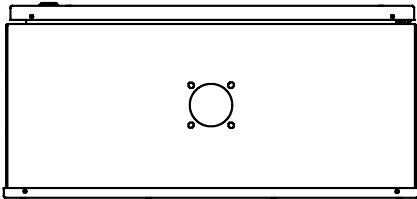
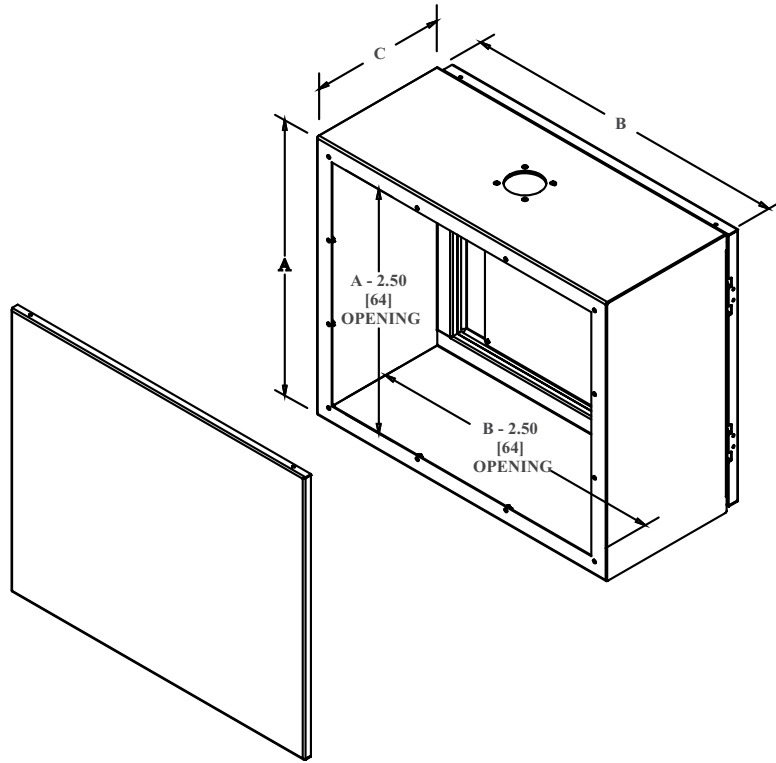

HMI ACCESSORIES

HMI KEYBOARD SHELF

Catalog No.	Height (A)	Width (B)	Depth (C)	Finish	Product Code
SCE-HMIKBS	4.52	18.00	13.69	Black Texture	P2
SCE-HMIKBSSS	4.52	18.00	13.69	Stainless Steel	P2

Designed for use on HMI enclosures. Mounting hardware is included.

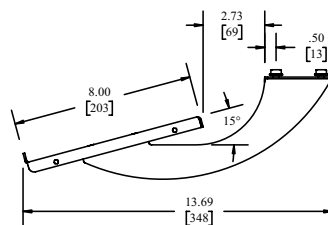
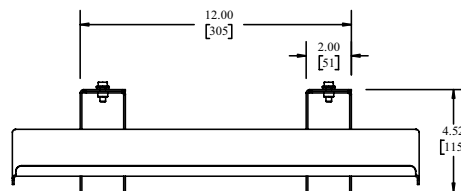
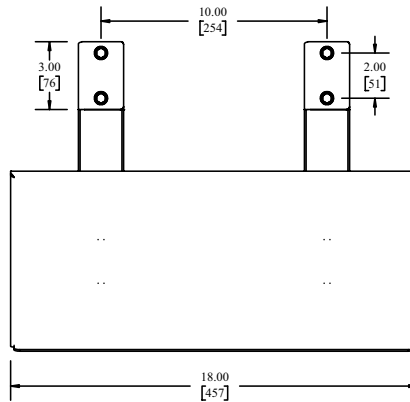

HMI ACCESSORIES

HMI PULL HANDLE

Catalog No.	Height (A)	Width (B)	Depth (C)	Qty Per Kit	Product Code
SCE-HMIPH5	5.28	2.57	2.84	1	P2
SCE-AUHK	12.00	4.27	3.15	1	P2

Designed for use on HMI enclosures. Handle is a steel tube plastic coated black with black molded polyamide plastic end stays. Mounting hardware is included.



SCE-HMIPH5



SCE-AUHK

HMI COVER PLATE

Catalog No.	Height (A)	Width (B)	Depth (C)	Qty Per Kit	Product Code
SCE-HMICPSS	3.50	3.50	0.08	1	P2

Gasketed cover plate for use on HMI enclosures when mounting cutout is not needed. Made of heavy gauge steel and powder coated RAL 7035 Gray.

