

# ENVIRO-THERM® THERMAL MANAGEMENT



## THERMOSTAT

Catalog No.	Used With	Height (A)	Width (B)	Depth (C)	Contact	Product Code
<a href="#">SCE-TEMNC</a>	Heater	2.40	1.26	1.42	NC	P1
<a href="#">SCE-TEMNO</a>	Fan	2.40	1.26	1.42	NO	P1

Designed to regulate air temperature in enclosures that operate with heaters or fans. This mechanical bi-metallic thermostat has a set point range of 30° to 140°F and is easily installed on 35 mm mounting rail. (NC) Contact normally closed, or (NO) Contact normally open, switch capacity 10 amp 120-250 VAC Resistive load and 1 amp 120-250V AC Inductive load, 1.25 amp 24V DC.

IS 24 - Industry Standards

UL Listed



## DUAL THERMOSTAT

Catalog No.	Used With	Height (A)	Width (B)	Depth (C)	Contact	Product Code
<a href="#">SCE-TEMDD</a>	Heater & Fan	2.00	2.00	2.00	NC & NO	P1

Designed to regulate air temperature in enclosures that operate with heaters and fans. This mechanical bi-metallic thermostat has a set point range of 30° to 140°F and is easily installed on 35 mm mounting rail. Dual functions as (NC) contact normally closed, or (NO) contact normally open, switch capacity 10 amp 120-250 VAC Resistive load and 1 amp 120-250V AC Inductive load, 1.25 amp 24V DC.

IS 24 - Industry Standards

UL Listed



## CHANGEOVER THERMOSTAT

Catalog No.	Used With	Height (A)	Width (B)	Depth (C)	Contact	Product Code
<a href="#">SCE-CTEM</a>	Heater, Fan, Light	2.36	1.54	2.10	NC & NO	P1

Designed to regulate air temperature in enclosures, can operate with heaters, fans or warning lights. Used to switch from heating to cooling. Switches one common contact immediately from one state (NC) to the other (NO) and vice versa. Has a set point range of 32°F to 140°F.

IS 24 - Industry Standards

UL Listed



## ELECTRONIC THERMOSTAT 24VDC

Catalog No.	Used With	Height (A)	Width (B)	Depth (C)	Product Code
<a href="#">SCE-TEMEVDC</a>	Thermoelectric Coolers	2.36	1.54	1.53	P1

Designed to regulate air temperature in enclosures and operate with the Thermoelectric Coolers. This electronic thermostat has a set point range of 14° to 176°F and is easily installed on 35 mm mounting rail. 24V DC 16A.

IS 24 - Industry Standards

UL Listed

## MECHANICAL HYGROSTAT

Catalog No.	Used With	Height (A)	Width (B)	Depth (C)	Product Code
<a href="#">SCE-HYGRQ</a>	Heater, Fan, Light	3.00	2.00	2.00	P1

Designed to regulate relative air humidity in enclosures. Mechanical hygrometers can operate with heaters, fans, or warning lights. Adjustable set point range of 40% to 90% humidity, maximum switch capacity 250V AC.

IS 24 - Industry Standards  
UL Listed



## BREATHER VENT

Catalog No.	Height (A)	Width (B)	Depth (C)	Product Code
<a href="#">SCE-BVK</a>	2.75	2.00	1.50	P1

Designed for indoor or outdoor applications to handle the large negative pressure differential caused in a tightly sealed enclosure in extreme weather conditions or wash down applications that draw water into the enclosure. Adding a Breather Vent will equalize this pressure differential. Installed on the side of your enclosure as a breather or installed on the bottom as a drain and vent.

Made of corrosion and UV resistant Polycarbonate material.

UL Listed 1, 2, 3, 3R, 3RX, 3S, 4, 4X & 12



## BLOWER PACKAGE

Catalog No.	Height (A)	Width (B)	Depth (C)	CFM	Voltage	Product Code
<a href="#">SCE-BP115</a>	5.75	18.88	6.95	190/230	115	P1
<a href="#">SCE-BP230</a>	5.75	18.88	6.95	190/290	230	

Designed for use in enclosures that require cooling but have limited space. Consists of a washable aluminum air filter, steel air plenum, removable stainless steel grille. Grille has captivated thumb nuts for easy access to the filter from the outside. Fan is 115 or 230 volt AC 50/60 Hertz (Hz). The 125 degree angled design provides greater air movement within the enclosure. Air plenum is ANSI 61 gray powder coated. UL listed motor.

IS 24 - Industry Standards  
UL Listed

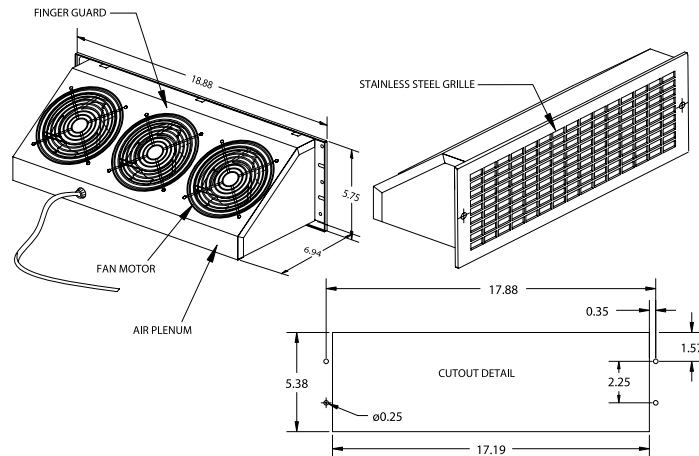

## BLOWER PACKAGE (FILTER AND GRILLE)

Catalog No.	Height (A)	Width (B)	Depth (C)	Product Code
<a href="#">SCE-FGABP</a>	5.75	18.88	0.22	P1

Designed for use with SCE Fan Packages and Filter and Grille Package. Aluminum washable filters provide good air filtration.

## REMOTE TEMPERATURE DISPLAY

Catalog No.	Height (A)	Width (B)	Depth (C)	Product Code
<a href="#">SCE-RMTD</a>	1.52	3.17	3.31	P1



## TYPE 12 FANS & FILTERS - BLACK

Easy to install snap fit design for use in enclosures that require cooling but have limited space in NEMA 1 and 12 applications. Housing and grill are made of black heat resistant (ABS-FR), self-extinguishing material. Fans are available in 115, 230 or 460 volt AC, 50/60 Hertz (Hz) single phase or 24 volt DC.

UL Listed Type 12



Catalog No.	Height (A)	Width (B)	Depth (C)	CFM	Cutout Size (F)	Product Code
<a href="#">SCE-N12FA33</a>	4.20	4.20	3.10	13/15	3.64 sq.	P'
<a href="#">SCE-N12FA33-230</a>	4.20	4.20	3.10	13/15	3.67 sq.	P1
<a href="#">SCE-N12FA33-24VDC</a>	4.20	4.20	3.10	20	3.64 sq.	P1
<a href="#">SCE-N12FA44</a>	5.91	5.91	2.88	26/29	5.03 sq.	P1
<a href="#">SCE-N12FA44-230</a>	5.91	5.91	2.88	39/47	5.03 sq.	P1
<a href="#">SCE-N12FA44-24VDC</a>	5.91	5.91	2.88	28	5.03 sq.	P1
<a href="#">SCE-N12FA66</a>	9.84	9.84	4.91	135/159	8.91 sq.	P1
<a href="#">SCE-N12FA66-230</a>	9.84	9.84	4.40	135/159	8.91 sq.	P1
<a href="#">SCE-N12FA66-24VDC</a>	9.84	9.84	4.40	86	8.91 sq.	P1
<a href="#">SCE-N12FA1010</a>	12.80	12.80	6.30	306/341	11.57 sq.	P1
<a href="#">SCE-N12FA1010-230</a>	12.80	12.80	6.30	306/341	11.57 sq.	P1
<a href="#">SCE-N12FA10HF</a>	12.80	12.80	6.24	483/547	11.45 sq.	P1
<a href="#">SCE-N12FA10HF-230</a>	12.80	12.80	6.27	483/547	11.45 sq.	P1
<a href="#">SCE-N12FA10HF-460</a>	12.80	12.80	6.24	483/547	11.45 sq.	P1

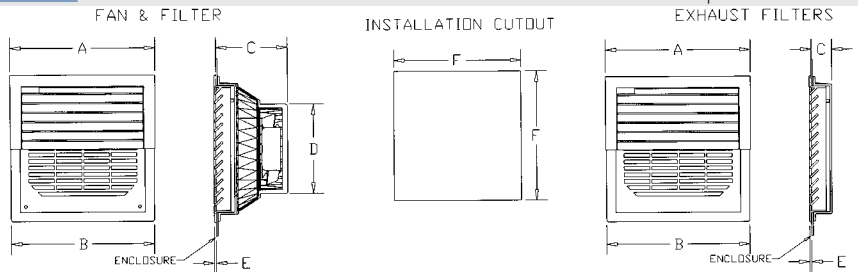

## TYPE 12 FANS & FILTERS - RAL 7035 GRAY

Easy to install snap fit design for use in enclosures that require cooling but have limited space in NEMA 1 and 12 applications. Housing and grill are made of gray heat resistant (ABS-FR), self-extinguishing material. Fans are available in 115, 50/60 Hertz (Hz) single phase or 24 volt DC.

UL Listed Type 12



Catalog No.	Height (A)	Width (B)	Depth (C)	CFM	Cutout Size (F)	Product Code
<a href="#">SCE-N12FA33LG</a>	4.20	4.20	3.14	13/15	3.64 sq.	P'
<a href="#">SCE-N12FA33-230LG</a>	4.20	4.20	3.10	13/15	3.67 sq.	P1
<a href="#">SCE-N12FA33-24VLG</a>	4.20	4.20	3.10	20	3.64 sq.	P1
<a href="#">SCE-N12FA44LG</a>	5.90	5.90	2.90	26/29	5.03 sq.	P1
<a href="#">SCE-N12FA44-24VLG</a>	5.90	5.90	2.90	28	5.03 sq.	P1
<a href="#">SCE-N12FA66LG</a>	9.80	9.80	4.90	135/159	8.91 sq.	P1
<a href="#">SCE-N12FA66-24VLG</a>	9.80	9.80	4.90	86	8.91 sq.	P1
<a href="#">SCE-N12FA1010LG</a>	12.80	12.80	6.30	306/341	11.57 sq.	P1

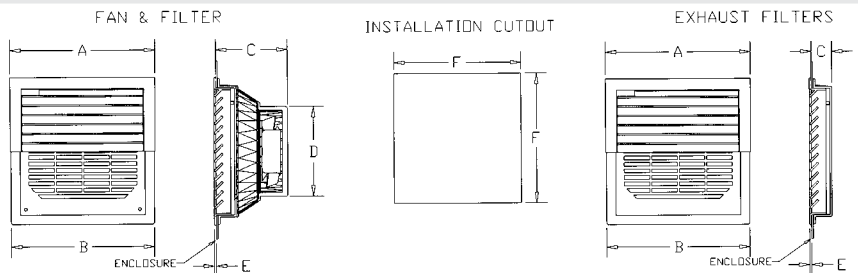

## TYPE 3R FANS & FILTERS

Easy to install snap fit design for use in enclosures that require cooling but have limited space in NEMA 3R applications. Grille is made of black UV and water resistant, self-extinguishing PVC material, housing is ABS material with steel inner guard for increased impact resistance. Fans are available in 115, 230 volt AC, 50/60 (Hz).

UL Listed Type 3R

Catalog No.	Height (A)	Width (B)	Depth (C)	CFM	Cutout Size (F)	Product Code
<a href="#">SCE-N3RFA44</a>	5.90	5.90	2.90	39/47	5.03 sq.	P1
<a href="#">SCE-N3RFA44-230</a>	5.90	5.90	2.90	39/47	5.03 sq.	P1
<a href="#">SCE-N3RFA66</a>	9.80	9.80	4.90	133/158	8.91 sq.	P1
<a href="#">SCE-N3RFA66-230</a>	9.80	9.80	4.90	133/158	8.91 sq.	P1
<a href="#">SCE-N3RFA1010</a>	12.80	12.80	6.30	306/341	11.57 sq.	P1
<a href="#">SCE-N3RFA1010-230</a>	12.80	12.80	6.30	306/359	11.57 sq.	P1
<a href="#">SCE-N3RFA10HF</a>	12.80	12.80	6.30	435/494	11.57 sq.	P1
<a href="#">SCE-N3RFA10HF-230</a>	12.80	12.80	6.30	435/494	11.57 sq.	P1

## TYPE 12 EXHAUST FILTERS - BLACK

Easy to install snap fit design for use on air discharge side of cooling fan package for Type 1 & 12 applications. Housing and grille are made of black heat resistant (ABS-FR), self-extinguishing material with a Type 12 filter. UL Listed Type 12

Catalog No.	Height (A)	Width (B)	Depth (C)	Cutout Size (F)	Product Code
<a href="#">SCE-N12FGA33</a>	4.20	4.20	0.50	3.64	P1
<a href="#">SCE-N12FGA44</a>	5.91	5.91	1.15	5.03 Sq.	P1
<a href="#">SCE-N12FGA66</a>	9.84	9.84	1.33	8.91 Sq.	P1
<a href="#">SCE-N12FGA1010</a>	12.8	12.8	1.34	11.57 Sq.	P1



Catalog No.	Height (A)	Width (B)	Depth (C)	Cutout Size (F)	Product Code
<a href="#">SCE-N12FGA33LG</a>	4.19	4.19	0.91	3.64	P1
<a href="#">SCE-N12FGA44LG</a>	5.91	5.91	1.15	5.03 Sq.	P1
<a href="#">SCE-N12FGA66LG</a>	9.84	9.84	1.33	8.91 Sq.	P1
<a href="#">SCE-N12FGA1010LG</a>	12.80	12.80	1.34	11.57 Sq.	P1

## TYPE 12 EXHAUST FILTER - RAL 7035 GRAY

Easy to install snap fit design for use on air discharge side of cooling fan package for Type 1 & 12 applications. Housing and grille are made of gray heat resistant (ABS-FR), self-extinguishing material with a Type 12 filter. UL Listed Type 12

## TYPE 3R EXHAUST FILTERS

Easy to install snap fit design for use on air discharge side of cooling fan package for Type 3R applications. Grille is made of black UV and water resistant, self-extinguishing PVC material, housing is ABS material with steel inner guard for increased impact resistance. UL Listed Type 3R

Catalog No.	Height (A)	Width (B)	Depth (C)	Cutout Size (F)	Product Code
<a href="#">SCE-N3RFGA44</a>	5.90	5.90	1.20	5.03 Sq.	P1
<a href="#">SCE-N3RFGA66</a>	9.80	9.80	1.30	8.91 Sq.	P1
<a href="#">SCE-N3RFGA1010</a>	12.80	12.80	1.30	11.57 Sq.	P1

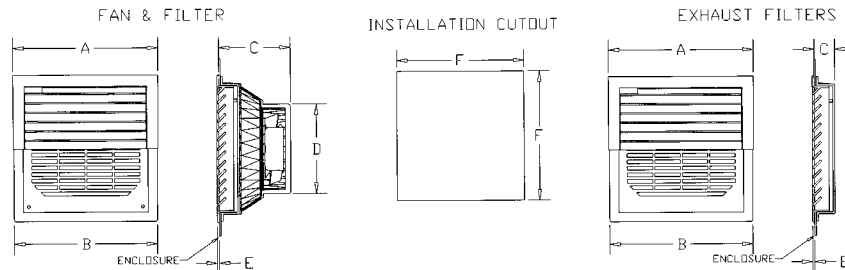

Catalog No.	Height (A)	Width (B)	Depth (C)	Cutout Size (F)	Cutout Size (G)	CFM	Product Code
<a href="#">SCE-FA44</a>	6.11	7.38	3.28	5.66	5.91	63/75	P1
<a href="#">SCE-FA44-230</a>	6.11	7.38	3.28	5.66	5.91	63/75	P1
<a href="#">SCE-FA44-24VDC</a>	6.11	7.38	3.28	5.66	5.91	155	P1
<a href="#">SCE-FA66</a>	7.61	8.88	3.75	7.16	7.41	135/158	P1
<a href="#">SCE-FA66-230</a>	7.61	8.88	3.75	7.16	7.41	135/158	P1
<a href="#">SCE-FA66-24VDC</a>	7.61	8.88	3.75	7.16	7.41	155	P1
<a href="#">SCE-FA1010</a>	11.62	12.88	5.25	11.16	11.41	400/440	P1
<a href="#">SCE-FA1010-230</a>	11.62	12.88	5.25	11.16	11.41	400/440	P1
<a href="#">SCE-FA1010-24VDC</a>	11.62	12.88	5.25	11.16	11.41	425	P1

## FAN PACKAGE

Designed for use in enclosures that require cooling but have limited space. Consists of a washable aluminum filter, steel air plenum, removable stainless steel grille, single phase fan, and approximately 14 inches of lead wire. Grille has captivated thumb nuts for easy access to the filter from the outside. Fans are available in 115 or 230 volt AC or 24 volt DC, 50/60 Hertz (Hz) single phase. Air plenum is ANSI-61 gray powder coated. For installation information, please consult our Installation Manual at [www.saginawcontrol.com](http://www.saginawcontrol.com). UL listed motor.

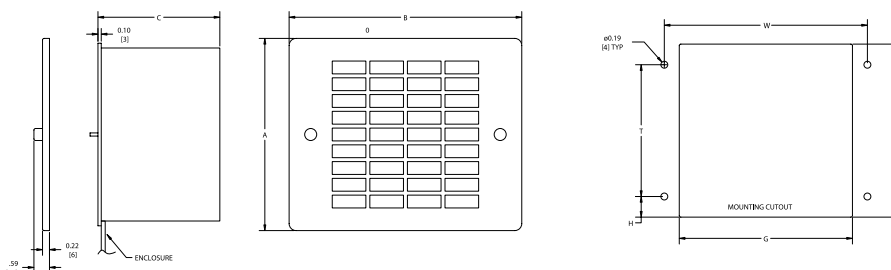

## FILTER AND GRILLE PACKAGE

Designed for use on air discharge side of cooling fan package. Stainless steel grille with captivated thumb screws. Aluminum mounting brackets and aluminum filter. Mounting hardware is furnished.

Catalog No.	Height (A)	Width (B)	Cutout Size (F)	Cutout Size (G)	Product Code
<a href="#">SCE-FGA44</a>	6.11	7.38	5.66	5.91	P1
<a href="#">SCE-FGA66</a>	7.61	8.88	7.16	7.41	P1
<a href="#">SCE-FGA1010</a>	11.62	12.88	11.16	11.41	P1

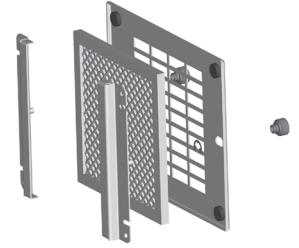

## RAIN HOOD WITH ACCESS COVER

Catalog No.	Height (A)	Width (B)	Depth (C)	Product Code
<a href="#">SCE-RH4N12</a>	9.44	8.25	4.50	P1
<a href="#">SCE-RH6N12</a>	13.44	12.25	4.50	P1
<a href="#">SCE-RH10N12</a>	16.44	15.25	4.50	P1
<b>Stainless Steel</b>				
<a href="#">SCE-RH4N12SS</a>	9.44	8.25	4.50	P1
<a href="#">SCE-RH6N12SS</a>	13.44	12.25	4.50	P1
<a href="#">SCE-RH10N12SS</a>	16.44	15.25	4.50	P1

Designed for use with Type 12 fan and filter kits to prevent rain, sleet, snow, dropping water or fluids from being drawn into the enclosure. Removable cover for easy access to fan and filter kits. Made of heavy gauge galvanized steel and powder coated ANSI-61 gray. "SS" kits are made of Type 304 stainless steel with #4 brushed finish. UL Recognized. For installation information, please consult our Installation Manual at [www.saginawcontrol.com](http://www.saginawcontrol.com). Note: Fan and Filter Kit are sold separately. UL Listed Type 3R

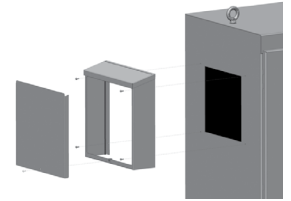

## 4X RAIN HOOD

Catalog No.	Height (A)	Width (B)	Depth (C)	Finish	Product Code
<a href="#">SCE-RH3N4XSS</a>	9.10	5.90	4.30	#4 Brushed Finish	P1
<a href="#">SCE-RH4N4XSS</a>	9.10	6.90	2.20	#4 Brushed Finish	P1
<a href="#">SCE-RH6N4XSS</a>	15.40	11.10	3.30	#4 Brushed Finish	P1
<a href="#">SCE-RH10N4XSS</a>	18.90	13.80	4.30	#4 Brushed Finish	P1

Designed for use in conjunction with the Type 12 Fan and Filter Packages to increase the ingress protection rating of the assembly to a 4X. 304 Stainless #4 brushed finish. Sanitary FDA compliant gaskets that make it easy to detect contamination. Removable rain hood for maintenance and replacement of filter without tools. For installation information, please consult our Installation Manual at [www.saginawcontrol.com](http://www.saginawcontrol.com).

Note: Fan and Filter Kit are sold separately.  
UL Listed Type 3, 3R, 4, 4X and 12  
IEC IP 65

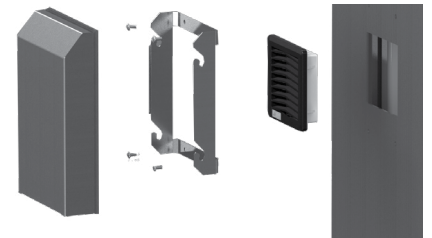

## RAIN HOOD

Catalog No.	Height (A)	Width (B)	Depth (C)	Finish	Product Code
<a href="#">SCE-RH44</a>	8.09	7.62	4.50	ANSI-61 Gray	P1
<a href="#">SCE-RH66</a>	8.46	9.24	4.56	ANSI-61 Gray	P1
<a href="#">SCE-RH1010</a>	12.34	13.12	4.50	ANSI-61 Gray	P1
<a href="#">SCE-RH66-05</a>	8.46	9.24	4.56	SCE-05 White	P1
<a href="#">SCE-RH1010-05</a>	12.34	13.12	4.50	SCE-05 White	P1
<b>Stainless Steel</b>					
<a href="#">SCE-RH44SS</a>	8.09	7.62	4.50	#4 Brushed Finish	P1
<a href="#">SCE-RH66SS</a>	8.46	9.24	4.56	#4 Brushed Finish	P1
<a href="#">SCE-RH1010SS</a>	12.34	13.12	4.50	#4 Brushed Finish	P1

Designed for use with standard fan and filter kits to prevent rain, sleet, snow, dropping water or fluids from being drawn into the enclosure. Made of heavy gauge galvanized steel and powder coated. "SS" kits are made of Type 304 stainless steel with #4 brushed finish. UL Recognized. For installation information, please consult our Installation Manual at [www.saginawcontrol.com](http://www.saginawcontrol.com).

Note: Fan and Filter Kit are sold separately.  
UL Listed Type 3R

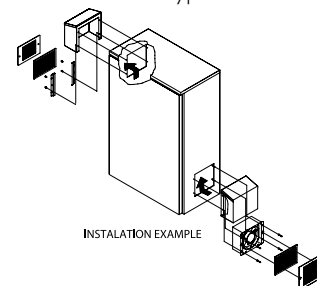
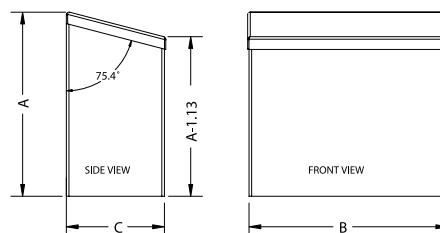

Catalog No.	Air Flow CU Feet Per Min.	Diameter	Fan Dim. Square	Depth	Produce Code
<a href="#">SCE-CF4</a>	95/115		4.69	1.52	P1
<a href="#">SCE-CF6</a>	203/238	6.72		2.00	P1
<a href="#">SCE-CF10</a>	600/665	10.00		3.50	P1
<a href="#">SCE-CF4-230</a>	95/115		4.69	1.52	P1
<a href="#">SCE-CF6-230</a>	203/238	6.72		2.00	P1
<a href="#">SCE-CF10-230</a>	600/665	10.00		3.50	P1



## COOLING FANS

Designed for use in enclosures where space is limited and reliable cooling is required. 115 or 230 volt AC 50/60 Hz. Single phase motor. A finger guard is included. UL listed motor.

**IS24 - Industry Standards**  
UL Listed

Catalog No.	Used on Cooling Fan Cat. No.	Product Code
<a href="#">SCE-GARD4</a>	SCE-CF4	P2
<a href="#">SCE-GARD6</a>	SCE-CF6	P2
<a href="#">SCE-GARD10</a>	SCE-CF10	P2

## FINGER GUARDS

A finger guard is included with each cooling fan. An additional finger guard can be mounted on either of the fans for maximum safety. Chrome plated.

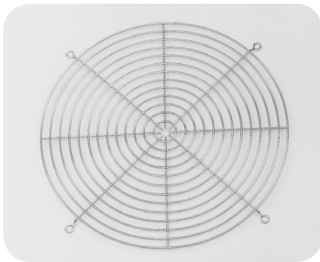

Catalog No.	Description	Height (A)	Width (B)	Depth (C)	(E)	(F)	(J)	Product Code
<a href="#">SCE-112399</a>	4" Fan Bracket	6.00	5.00	1.50	-	3.00	0.62	P2
<a href="#">SCE-111252</a>	6" Fan Bracket	10.00	6.88	2.00	-	5.00	1.00	P2
<a href="#">SCE-110551</a>	10" Fan Bracket	13.50	10.12	3.50	4.00	4.00	2.00	P2

## COOLING FAN BRACKET

Cooling fan brackets are designed for general circulation or to direct air in a problem area. Brackets are made of heavy gauge steel and powder coated white. Fans and finger guards are ordered separately.

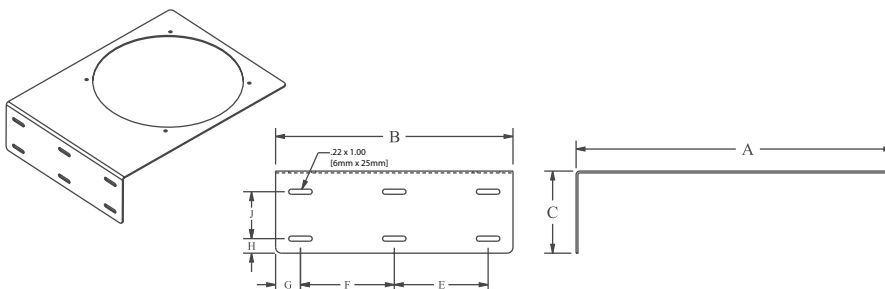

# ENVIRO-THERM® THERMAL MANAGEMENT

## FAN HEATER WITH THERMOSTAT

Designed to protect electrical controls, instruments and sensitive components from low temperatures and the effects of condensation and corrosion by maintaining a stable temperature within the electrical enclosure. These heaters are not intended for use in hazardous, wet, dusty or dirty locations. For installation information, consult our Installation Manual at [www.saginawcontrol.com](http://www.saginawcontrol.com).

**IS24 - Industry Standards**  
UL Component Recognized

Catalog No.	Watt @ 60 Hz	Volt	Height	Width	Depth	Product Code
<a href="#">SCE-HF1251A</a>	125	115	5.50	4.00	4.50	P1
<a href="#">SCE-HF1252A</a>	125	230	5.50	4.00	4.50	P1
<a href="#">SCE-HF2001A</a>	200	115	5.50	4.00	4.50	P1
<a href="#">SCE-HF2002A</a>	200	230	5.50	4.00	4.50	P1
<a href="#">SCE-HF4001B</a>	400	115	7.50	4.00	4.50	P1
<a href="#">SCE-HF4002B</a>	400	230	7.50	4.00	4.50	P1
<a href="#">SCE-HF8001B</a>	800	115	7.50	4.00	4.50	P1
<a href="#">SCE-HF8002B</a>	800	230	7.50	4.00	4.50	P1



- Brushed Aluminum Housing
- Thermostat Range 0° to 100°F (-18° to 38°C)
- Heat discharge at the top of the heater
- Panel mount
- Air volume of 16 CFM on 125 & 200 Watt heaters, 26 CFM on 400 & 800 Watt heaters
- Heat indicator light
- Switch for Auto or Fan
- UL Recognized
- CSA Approved
- CE

## FAN HEATER

Compact design that heats up dynamically and is quiet during operation. Din rail clip design for 15mm, 35mm and C-Din Rail. 14" heater cable, 10" fan cable. 100 - 240V 50/60 Hz Heater and 24 V Integrated fan. For installation information, consult our Installation Manual at [www.saginawcontrol.com](http://www.saginawcontrol.com).

**IS24 - Industry Standards**  
UL Component Recognized

Catalog No.	Watts	Max Current	Height	Width	Depth	Product Code
<a href="#">SCE-H350</a>	350	3.0 A	3.10	2.10	3.30	P1

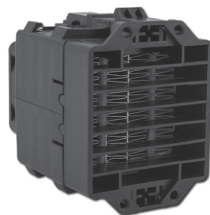

## TOUCH SAFE HEATER

PTC (Positive Temperature Coefficient) Din rail clip design for 35mm Din Rail. Designed for protection from low temperatures, condensation and corrosion. Touch Safe with 2 screw terminal for standard AWG 14 wire. 110 - 240V AC or DC. For installation information, consult our Installation Manual at [www.saginawcontrol.com](http://www.saginawcontrol.com).

**IS24 - Industry Standards**  
UL Component Recognized

Catalog No.	Watts	Max Current	Height	Width	Depth	Product Code
<a href="#">SCE-TSH25</a>	25	2.5 A	4.92	1.61	1.61	P1
<a href="#">SCE-TSH50</a>	50	3.5 A	4.92	1.61	1.61	P1
<a href="#">SCE-TSH75</a>	75	4.0 A	5.51	2.76	2.48	P1
<a href="#">SCE-TSH100</a>	100	5.0 A	5.51	2.76	2.48	P1
<a href="#">SCE-TSH150</a>	150	9.5 A	8.66	2.76	2.48	P1



Catalog No.	Height (A)	Width (B)	Cutout Size (F)	Cutout Size (G)	Product Code
<a href="#">SCE-AVK23</a>	3.25	3.25	2.00	1.75	P2
<a href="#">SCE-AVK33</a>	3.88	4.50	2.62	3.00	P2
<a href="#">SCE-AVK34</a>	4.75	4.50	3.50	3.00	P2
<a href="#">SCE-AVK43</a>	4.50	5.50	3.25	4.00	P2
<a href="#">SCE-AVK44</a>	5.63	5.50	4.38	4.00	P2
<a href="#">SCE-AVK64</a>	5.63	7.50	4.38	6.00	P2
<a href="#">SCE-AVK66</a>	7.88	7.50	6.62	6.00	P2
<a href="#">SCE-AVK84</a>	5.81	9.50	14.06	8.00	P2
<a href="#">SCE-AVK86</a>	8.18	9.50	4.56	8.00	P2
<a href="#">SCE-AVK88</a>	10.56	9.50	6.94	8.00	P2
<a href="#">SCE-AVK812</a>	15.31	9.50	9.31	8.00	P2
<b>Stainless Steel</b>					
<a href="#">SCE-AVK23SS</a>	3.25	3.25	2.00	1.75	P2
<a href="#">SCE-AVK33SS</a>	3.88	4.50	2.62	3.00	P2
<a href="#">SCE-AVK34SS</a>	4.80	4.50	3.50	3.00	P2
<a href="#">SCE-AVK43SS</a>	4.50	5.50	3.25	4.00	P2
<a href="#">SCE-AVK44SS</a>	5.63	5.50	4.38	4.00	P2
<a href="#">SCE-AVK64SS</a>	5.63	7.50	4.48	6.00	P2
<a href="#">SCE-AVK66SS</a>	7.88	7.50	6.62	6.00	P2
<a href="#">SCE-AVK84SS</a>	5.81	9.50	14.06	8.00	P2
<a href="#">SCE-AVK86SS</a>	8.19	9.50	4.56	8.00	P2
<a href="#">SCE-AVK88SS</a>	10.56	9.50	6.94	8.00	P2
<a href="#">SCE-AVK812SS</a>	15.31	9.50	9.31	8.00	P2

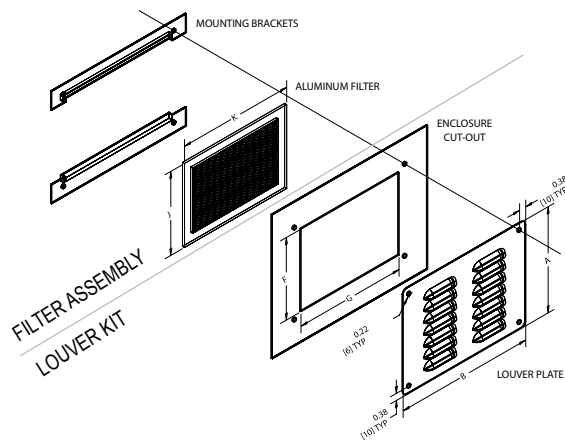

Catalog No.	Filter Size (J)	Filter Size (K)	Product Code
<a href="#">SCE-FLT33</a>	3.22	3.25	P2
<a href="#">SCE-FLT34</a>	4.09	3.25	P2
<a href="#">SCE-FLT43</a>	3.84	4.25	P2
<a href="#">SCE-FLT44</a>	4.97	4.25	P2
<a href="#">SCE-FLT64</a>	4.45	6.25	P2
<a href="#">SCE-FLT66</a>	6.72	6.25	P2
<a href="#">SCE-FLT84</a>	4.64	8.25	P2
<a href="#">SCE-FLT86</a>	7.02	8.25	P2
<a href="#">SCE-FLT88</a>	9.39	8.25	P2
<a href="#">SCE-FLT812</a>	14.14	8.25	P2

## LOUVER KIT

Designed for ventilation in enclosures where excessive heat or moisture is a problem. Kits may be installed in the field by making a cutout of the proper size. Louver plates are made of heavy gauge steel and powder coated ANSI-61 gray. "SS" parts are made of Type 304 stainless with #4 brushed finish.

## FILTER ASSEMBLY

Designed for use with louver kit. Consists of aluminum filter brackets with mounting holes to align with louver mounting holes and a washable aluminum air filter to provide good air filtration. For installation information, please consult our Installation Manual at [www.saginawcontrol.com](http://www.saginawcontrol.com).