

# Technical Manual

Operation and installation

**DATAWIND FILTERFAN® 115V / 230V**

Version 1.0, September 2020



## 1 : INSTALLATION

1. Remove cutting template (#13) from bag, unfold, and tape to desired mounting surface. Make sure template is flat and level.
2. Cut / drill out the areas shaded with diagonal lines.
3. Peel back backing on weather gaskets and apply to the enclosure side of the fan housing as shown:

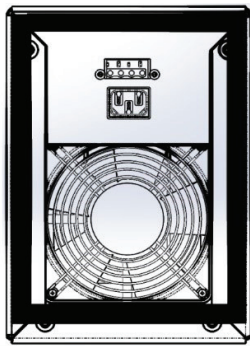

DPF 22000

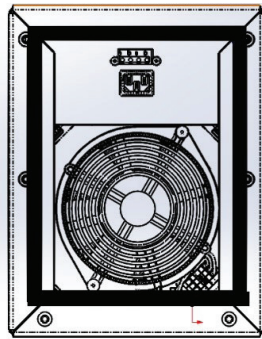

DPF 33000 SL

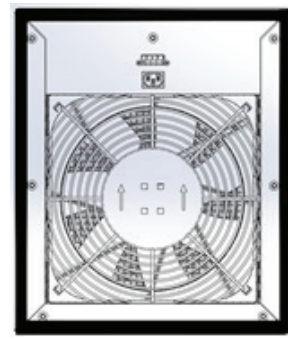

DPF 67000

4. Screw the provided studs (#2) into the top corner nuts on the fan housing. Use these to hang the fan from the mounting holes and secure them with the nuts and washers provided (#3, #4, & #8).
5. Secure the rest of the fan housing with the remaining bolts and washers (#3, #4, & #5).
6. Using the sheet metal screws provided (#17), mount the din rail (#16) to the desired location within the enclosure for the thermostat. Typically this is where the most heat is expected. Preferably use #32 or 3mm size bit for screw hole.
7. Mount dual thermostat to the rail and plug the cable into the matching plug on the fan unit. The left thermostat dial is for fan cycle temperature and the right controls the indicator light (factory preset for fan cycle and indicator light should be 85°F and 95°F respectively). Use zip-ties and mounts (#14 & #15) to manage cable routing if need be.
8. Plug power cable (#12) into the IEC connector on the fan unit and then into power source. Fan should run once power is connected and thermostat minimum setting is met

## 2 : TECHNICAL DATA

Model	Unimpeded Flow Rate (CFM)	Voltage	Hz	Current (A)	Power Consumption (W)	Running Temp	Storage Temp	Dimensions (H x W x D)
DPF 22000	38	115V AC	50/60	0.235/0.23	20/20	-40 ... +55°C	-40 ... +70°C	9.4" x 6.8" x 2.8"
		230V AC	50/60	0.12/0.18	19/18	-40 ... +131°F	-40 ... +158°F	
DPF 33000 SL	152	115V AC	50/60	0.56/0.47	41/38	-40 ... +55°C	-40 ... +70°C	11.9" x 9.3" x 3.3"
		230V AC	50/60	0.31/0.25	45/39	-40 ... +131°F	-40 ... +158°F	
DPF 67000	560	115V AC	50/60	1.18/1.71	135/196	-40 ... +55°C	-40 ... +70°C	17.5" x 14.9" x 5.5"
		230V AC	50/60	0.62/0.86	140/197	-40 ... +131°F	-40 ... +158°F	

Indicator Light	Voltage	Current
RED	110 ... 230V AC	<3mA

Dual Thermostat	Setting Temp	Contactors	Dimensions (H x W x D)
FLZ 543	0 ... +60°C +30 ... +140°F	NO/NO	3.17" x 2.32" x 1.46"

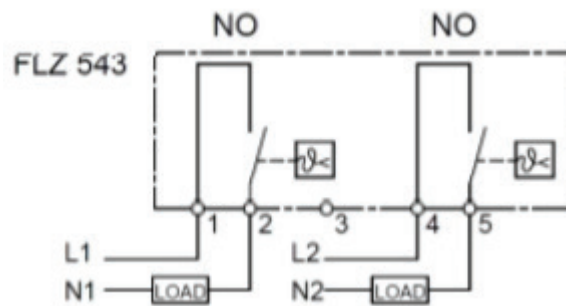

### 3 : FILTER MEDIA REPLACEMENT



**CAUTION**

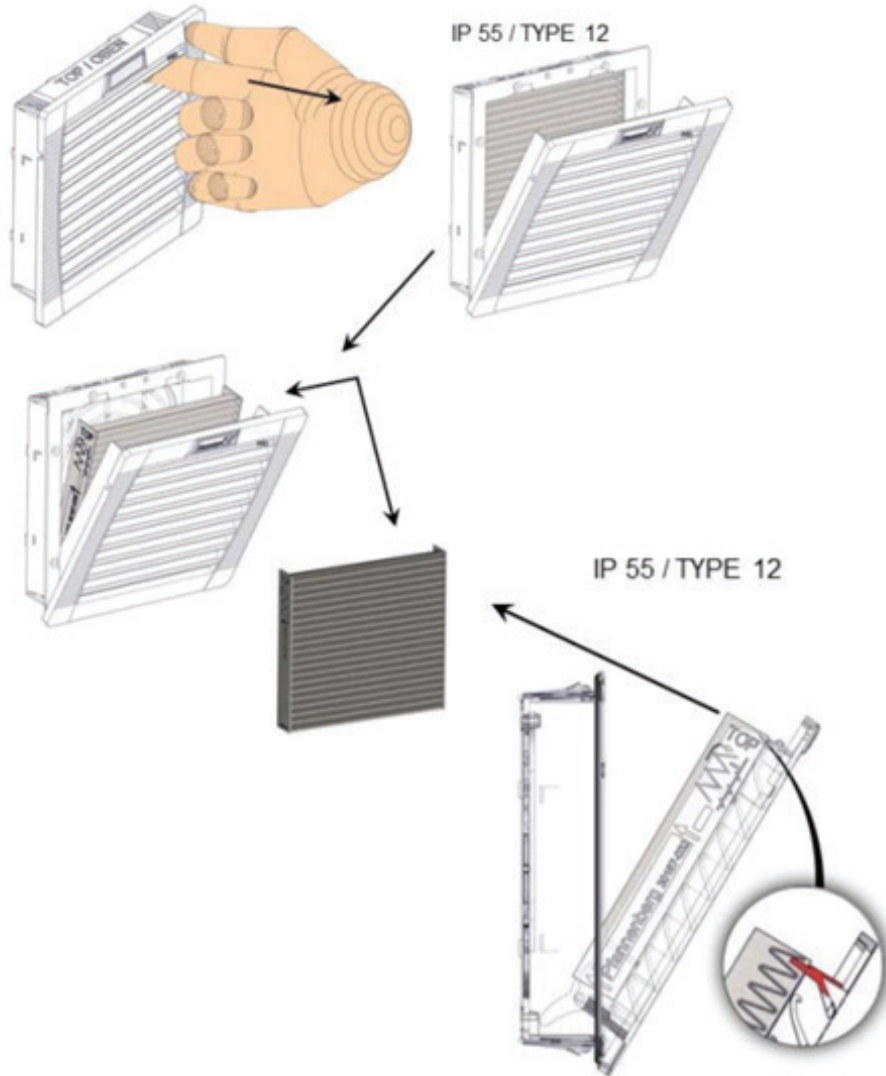

Model	Replacement Filters
DPF 22000	18611600034
DPF 33000 SL	18611600035
DPF 67000	18611600037

**IP 55/ TYPE 12:** Make sure that the filter is installed in the proper position  
Recommended replacement intervals can be found at <https://www.pfannenberg.com/en/service-support/manuals/>