

Features

- Mounting brackets for 6500 external or internal mounting
- Mounting hardware included
- 316 Stainless steel material
- Universal external mount for top, bottom, side mounting
- Easy mounting bracket to most flat panels for internal mounting

Application

To be used with the 6500 control unit for easy external or internal mounting to the pressurized enclosure.

Includes mounting bracket to secure the 6500 control unit to the enclosure, as well as the necessary mounting equipment.

The 6500-01-EXT1-*BKT01 is for mounting the 6500 to the enclosure externally.

The 6500-01-INT1-BKT01 is for mounting the 6500 inside the enclosure or to a flat panel.



CE

General specifications	
Operating mode	For mounting 6500 control unit to enclosure or back panel
Series	6500
Mechanical specifications	
Material	Bracket: 316L stainless steel Mounting bolts (bracket to enclosure): (4) M6, 316 stainless steel (included) Sealing washers: (4) silicon rubber (included) Mounting bolts (EPCU to bracket): (1) M4x0.7, 316 stainless steel (included)
Mass	6500-01-EXT1-BKT01: 1.8 kg 6500-01-INT1-BKT01: 2 g
Dimensions	see dimension drawing
General information	
Scope of delivery	(2) brackets included for each 6500-01-INT1-BKT01

Dimensions

6500-01-EXT1-BKT01

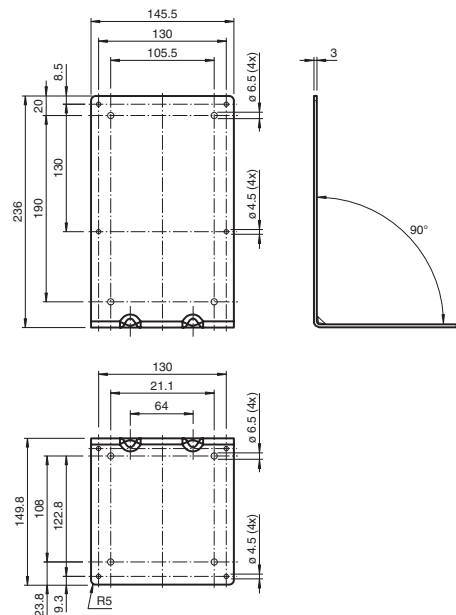

6500-01-INT1-BKT01

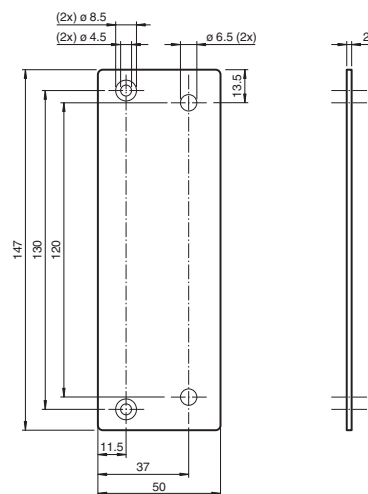

Type code/model number

