

# PY X-S-05 – Beacon Operating and installation instruction

## Dimensions

Content of package:

- 1x Alarm device
- 1x Diaphragm nipple M20
- 1x Operating instruction
- 1x Resistor (only –SSM)

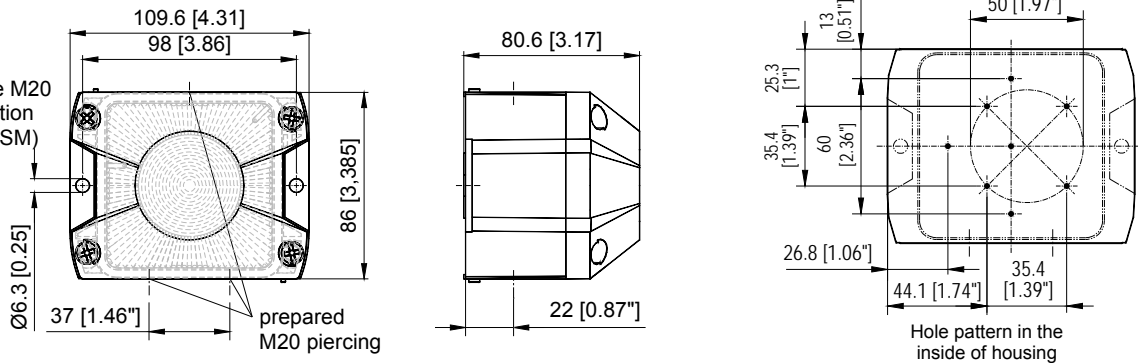

## Technical Data

Flash energy	5J					
Rated effective luminous intensity	44 cd (clear)					
Flash frequency	1Hz					
Rated voltage	12 V DC	24V DC	48V DC	24V AC 50/60 Hz	115 V AC, 50/60 Hz	230V AC 50/60 Hz
Operating voltage range	10 – 15 V DC	18 – 30 V DC	40 – 60 V DC	18 – 30 V AC	95 - 127 V AC	195 – 253 V AC
Current consumption (max)	700 mA	360 mA	170 mA	800 mA	120 mA	90mA
Power consumption	7,5 W	9,5 W	7,5 W	30 VA	14,5 VA	21,5 VA
Duty cycle	100%					
Connection terminal	0,14 - 2,5mm <sup>2</sup> / AWG24 - AWG 14 (stranded)					
Protection system	IP66 (EN60529), Type 4 & 4x					
Resistance against impact	IK08 (EN50102)					
Protection class	II  Double insulated equipment					
Operating temperature	-40°C...+55°C					
Storage temperature	-40°C...+70°C					
Max. rel. Humidity	90%					
Cable entry	4x M20 (prepared) 7 – 13 mm					
Sealing range of diaphragm nipple	With the use of cable diameters <7 mm, a cable screw joint with sufficient ingress protection must be provided					
Material of housing	PC/ABS Blend					
Material of lens	PC					
Installation position	arbitrary					
Options	-SSM (see page 4)					
Accessory	Sealing plug (Art-no. 28300000002)					
Lens colours	clear, white, yellow, amber, red, green, blue					

## Approvals

<b>Approvals (valid for marked equipment)</b>																			
	<table border="1"> <tr> <td colspan="2"><b>VdS 0786-CPD-21219</b></td> </tr> <tr> <td>Options</td> <td>–SSM (24V DC only)</td> </tr> <tr> <td>Rated voltage</td> <td>24V DC                      48V DC</td> </tr> <tr> <td>Operating voltage range acc. to EN54-23</td> <td>18V – 30V                      40 – 60V DC</td> </tr> <tr> <td>Lens colours</td> <td>red, clear</td> </tr> <tr> <td>Signalling area</td> <td>EN 54-23 Category O: see document 30320-005-1</td> </tr> <tr> <td>Environmental protection class</td> <td>Type B</td> </tr> <tr> <td>Installation position</td> <td>see document 30303-005-1</td> </tr> <tr> <td colspan="2">Testing takes place using the supplied diaphragm nipple and the outer fastening bores.</td> </tr> </table>	<b>VdS 0786-CPD-21219</b>		Options	–SSM (24V DC only)	Rated voltage	24V DC                      48V DC	Operating voltage range acc. to EN54-23	18V – 30V                      40 – 60V DC	Lens colours	red, clear	Signalling area	EN 54-23 Category O: see document 30320-005-1	Environmental protection class	Type B	Installation position	see document 30303-005-1	Testing takes place using the supplied diaphragm nipple and the outer fastening bores.	
	<b>VdS 0786-CPD-21219</b>																		
	Options	–SSM (24V DC only)																	
	Rated voltage	24V DC                      48V DC																	
	Operating voltage range acc. to EN54-23	18V – 30V                      40 – 60V DC																	
	Lens colours	red, clear																	
	Signalling area	EN 54-23 Category O: see document 30320-005-1																	
	Environmental protection class	Type B																	
Installation position	see document 30303-005-1																		
Testing takes place using the supplied diaphragm nipple and the outer fastening bores.																			
VdS	<b>G212186</b> Lens color: red and clear, data see Construction Product Regulation (305/2011/EC) <b>G217016</b> Lens color: white, yellow, amber, green, blue. These lens colors are not certified according to EN54-23 and are not be used for alerting in case of fire.																		
GL	<b>61062-13 HH</b> Environmental Category C, H, EMC1																		
CNBOP	<b>2016/2014</b>																		
UL, cUL	<table border="1"> <tr> <td>Rated Voltage</td> <td>Visual Signal Appliance - General Signaling Equipment - UEES, UEES7</td> </tr> <tr> <td>115V AC 230V AC 24V AC 12V DC 24V DC 48V DC</td> <td>           Suitable for indoor and outdoor use.            Warning: Not to be used as a Visual Public Mode Alarm Notification Appliance.             According to CSA-C22.2 No. 205-M1983 clause 4.3.4 the connection is limited to max. three leads.         </td> </tr> </table>	Rated Voltage	Visual Signal Appliance - General Signaling Equipment - UEES, UEES7	115V AC 230V AC 24V AC 12V DC 24V DC 48V DC	Suitable for indoor and outdoor use. Warning: Not to be used as a Visual Public Mode Alarm Notification Appliance.  According to CSA-C22.2 No. 205-M1983 clause 4.3.4 the connection is limited to max. three leads.														
	Rated Voltage	Visual Signal Appliance - General Signaling Equipment - UEES, UEES7																	
115V AC 230V AC 24V AC 12V DC 24V DC 48V DC	Suitable for indoor and outdoor use. Warning: Not to be used as a Visual Public Mode Alarm Notification Appliance.  According to CSA-C22.2 No. 205-M1983 clause 4.3.4 the connection is limited to max. three leads.																		

PYRA Xenon beacons PY X-S-05 comply with the limits for a Class B digital device, pursuant to part 15 of the FCC Rules

## Taking into operation

### Safety notes:

- Installation must be carried out by an electrician in compliance with the latest codes and regulations.
- Danger: High voltage may be present.
- Prior to opening, it must be ensured that no voltage is applied to the device.
- Before electrical connection, the supply voltage on the type plate is to be checked. The wrong operating voltage can lead to damages or to the destruction of the equipment.
- During installation it must be ensured that the connection cables are secured against tension and distortion.  
Please observe: The devices are not designed for portable use.
- CAUTION: When making installation, route field wiring away from sharp projections, corners and internal components.
- The function of the unit is only guaranteed if the upper and lower section is joined correctly.
- In order to prevent detriment to sight, continuously looking directly in the activated light is to be avoided.

### Opening the housing

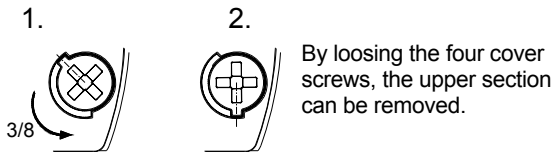

By loosening the four cover screws, the upper section can be removed.

### Closing the housing

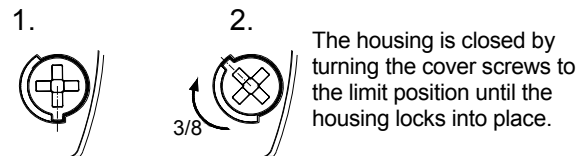

The housing is closed by turning the cover screws to the limit position until the housing locks into place.

The unit is not closed when delivered.

Sealing plugs for the housing screws are available as accessories.

### Electrical connection:

#### Circuit board for electrical connection (located in the base section):

Connecting cables:

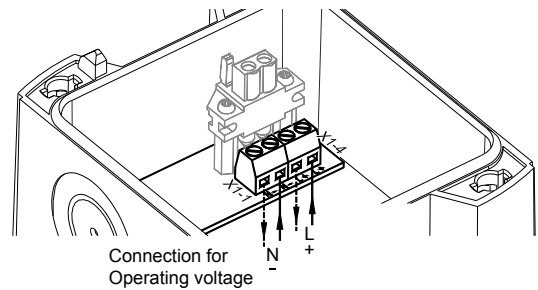
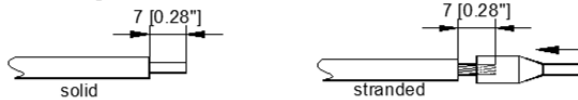

#### Option –SSM (Soft-Start-Module) (24V DC only):

- Limiting of the switch-on current peak to max. 2.1A
- Connection of the operating voltage to the equipment starts at >7V
- Resistance for the line monitoring connected.

Operating voltage range: 18V – 30V DC

#### Connection of a resistor for line monitoring:

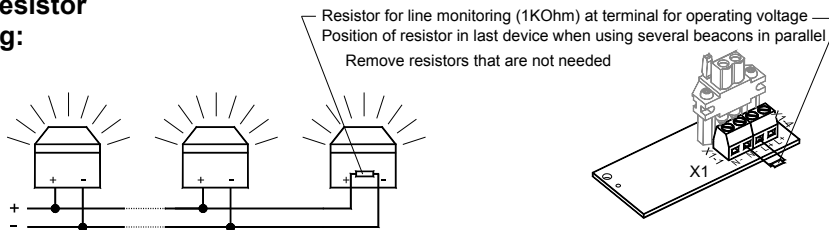

#### Cable gland entries

To guarantee the specified protection type, cable grommets with a protection type of IP 66 are to be installed at the openings provided for this purpose. The supplied diaphragm nipple can be replaced with a cable gland or with an M12 plug connection with a flange measurement of M20.

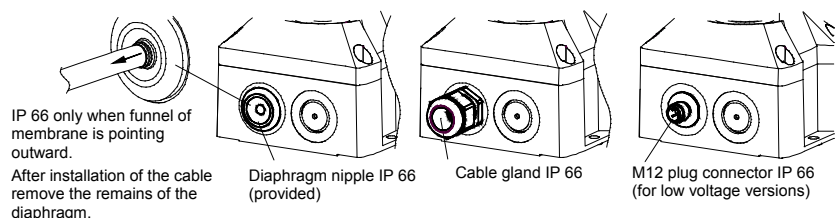

#### Maintenance, Service and Ordering Spare Parts

The device does not require any special maintenance. External cleaning should be done with a mild soap solution without the use of solvents. The device may only be operated in the undamaged state within the specified rating.

Conversions, alterations, improper and inadmissible use as well as the non-observance of the notes in these operating instructions shall render the warranty null and void.

Components may be replaced only by original spare parts. As a matter of principle, repairs are to be carried out in the manufacturing works.