

How To Order

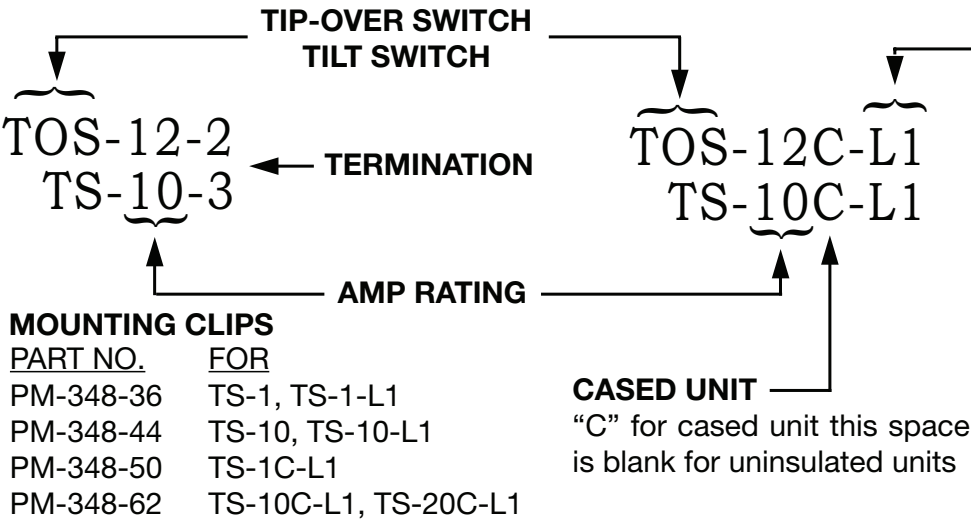

TERMINATION

All leaded and cased tilt switches come with silicone rubber mercury switch lead wire, except TOS-12

* TERMINATION WIRE LENGTHS

- L1 = 6" Leads
- L2 = 12" Leads
- L3 = 18" Leads
- L4 = 24" Leads

(CONTINUES IN 6" INCREMENTS)

For lead wire or lengths other than the above contact the factory

Tilt Switches *Mercury & Mechanical (Non-Mercury)*

TS-1 & WATS-1

Tilt Switch 10°

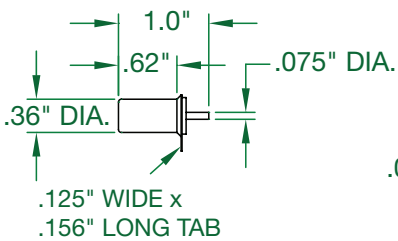

TS-1-3

WATS-1-3

Printed circuit mountable Tilt Switch

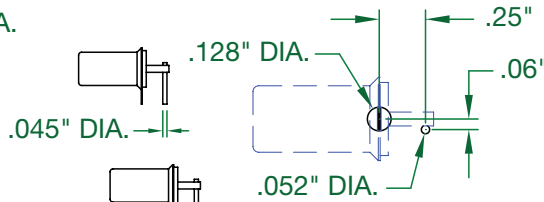

Hole pattern side opposite component

TS-1-6

WATS-1-6

Standard

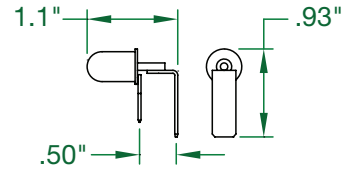

SP-1357

(Mechanical NON-Mercury)

With 1/4" Quick Connects

TS-10 & TS-20

Tilt Switch 10°

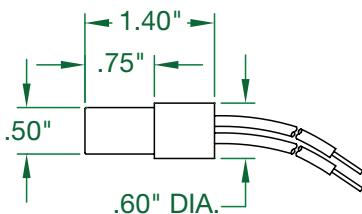
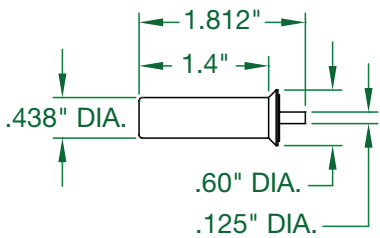

NATS-20

Narrow Angle Tilt Switch 30°

WATS-20

Wide Angle Tilt Switch 90°

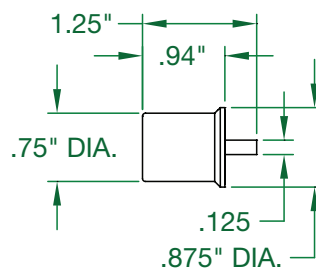

RATINGS:

TS-1 & WATS-1

1 AMP @ 120 VAC / 1 AMP @ 28 VDC

SP-1357 & SP-1358-L*

1 AMP @ 6-24 VDC

TS-10

10 AMP @ 120 VAC

TS-20

20 AMP @ 120 VAC

NATS-20 & WATS-20

13 AMP @ 120 VAC

6 AMP @ 240 VAC

TS-10C-L*

TS-20C-L*

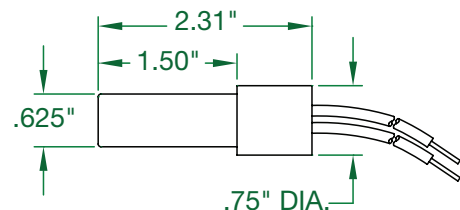

TS-1C-L* (Mercury)

WATS-1C-L* (Mercury)

SP-1358-L* (Mechanical NON-Mercury)

Tip-Over Switches *Mercury & Mechanical (Non-Mercury)*

SP-1431
(Mechanical Non-Mercury)
 Tip-Over 30-50°

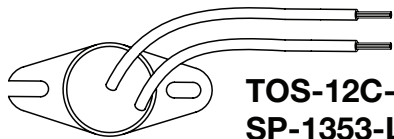
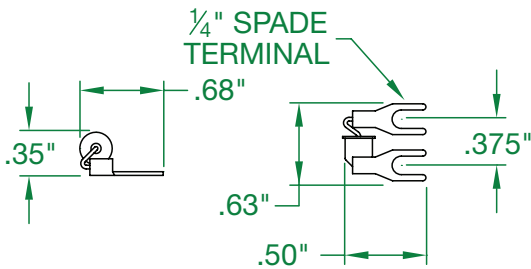

TOS-12C-L*
SP-1353-L* Mechanical

TOS-12-2
 Tip Over Switch 25°

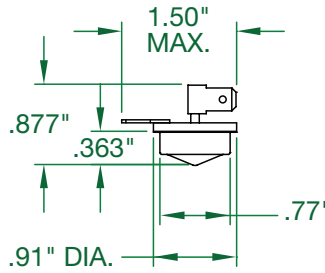

RATINGS:

SP-1431
 0.25 AMPS @ 60 V
 3 VA Max.
 40° Tip Over Angle

SP-1353
 1 AMP @ 120 VAC
 0.4 AMP @ 240 VAC
 25° Tip Over Angle

TOS-12
 12 AMPS @ 120 VAC
 25° Tip Over Angle

TOS-12C-8

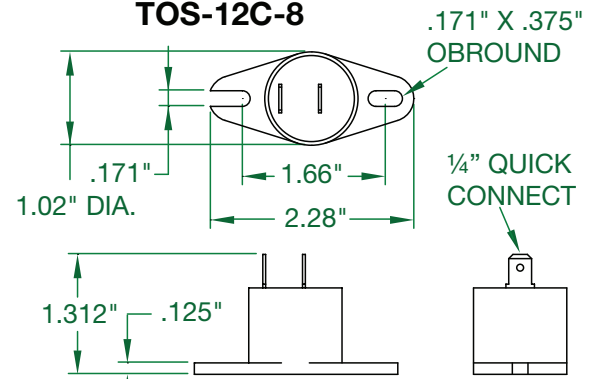

Damper Arm Tilt Switch

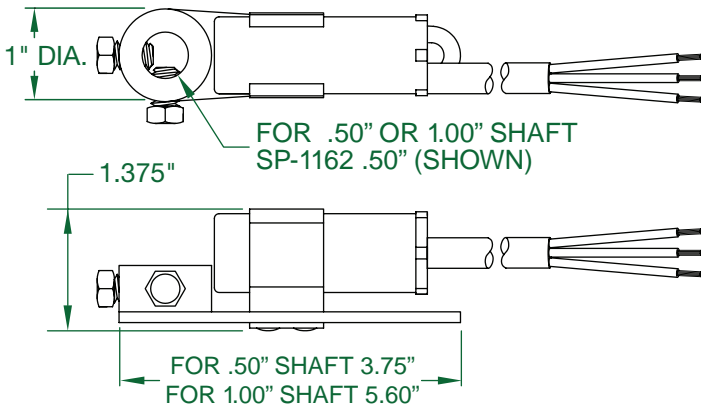

SP-1162-L
 SPDT - .50" SHAFT - 18 AWG Plenum wire
SP-1442-L
 SPDT - 1.00" SHAFT - 18 AWG Plenum wire
SP-1335-L
 SPDT - .50" SHAFT - 18 AWG SJOW Cord
RATINGS
 1 AMPS @ 120 VAC / 1 AMP @ 28 VDC

Mechanical DATS (Non-Mercury)

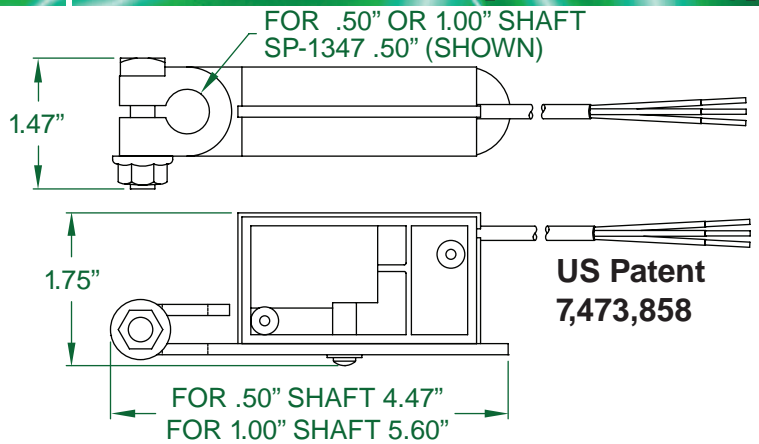

SP-1347-L
 SPDT - .50" SHAFT - 18 AWG Plenum wire
SP-1450-L
 SPDT - 1.00" SHAFT - 18 AWG Plenum wire
RATINGS
 5 AMPS @ 120 VAC / 5 AMP @ 30 VDC

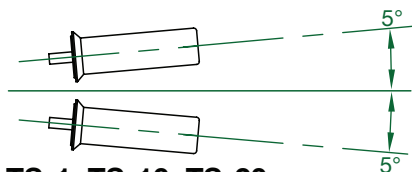

TS-1, TS-10, TS-20
 Operating Angle
 Recommended operating angle for good switch open and closure conditions.

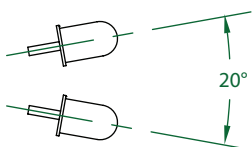

SP-1357 & SP-1358
 Operating Angle

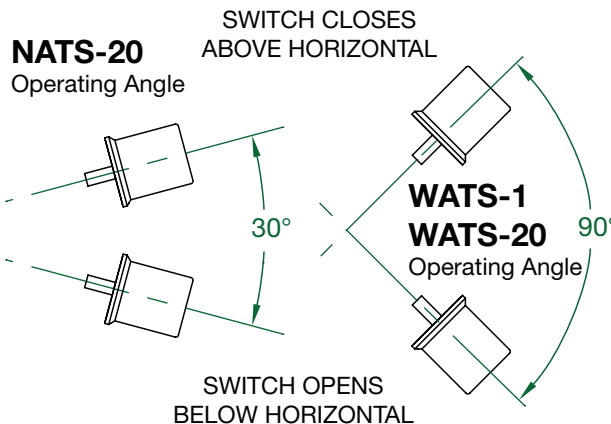

TOS-12, SP-1353 & SP-1431 (Operating Angle is 40°)
 Omni Directional Operating Angle

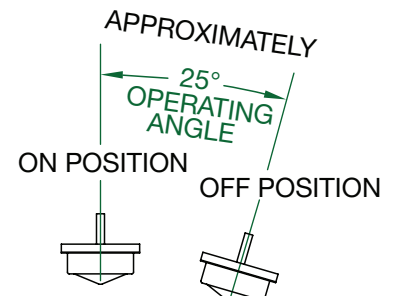

15° & 45° Operating Angle Available
 Contact the Factory