



Starvert iS7

High Performance AC Drive

3Φ 200V: 0.75kW~75kW
3Φ 400V: 0.75kW~375kW



Powerful Performance

- Ride Through for the sudden power failure(Kinetic Energy Buffering)
- PM Sensorless Vector control for PMSM



Various Options

- Profibus-DP, DeviceNet, Lonworks, Ethernet-IP, CC-Link, CANopen, Modbus-TCP, Rnet communication option
- Extended I/O , PLC card option, Encoder card option, etc..



User & Environment-friendly

- Wider LCD Keypad and User & Macro Group
- Built-in EMC Filter for reducing electronic distortion
- Built-in DC Reactor for harmonic reduction and PF improvement

Specification

Item		Description	
Control	Control Mode	V/F, V/F PG, Slip Compensation, Sensorless Vector-1, Sensorless Vector-2, Vector Control	
	Frequency Setting Resolution	Digital Command : 0.01Hz Analog Command : 0.08Hz (Max. Frequency : 60Hz)	
	Frequency Tolerance	Digital Command : 0.01% of the Max. Frequency Analog Command : 0.1% of the Max. Frequency	
Operation	Run/Stop Type	Keypad / Terminal / Communication	
	Frequency Setting	Digital Command : Keypad Analog Command : 0 ~ 10[V] / -10 ~ 10[V] / 0 ~ 20[mA]	
	Functions	PID, Auto-tuning, Auto-restart, Kinetic Energy Buffering, Flying Start, Low leakage Operation, etc.	
Input	Digital Inputs (8)	Selectable between NPN (Sink) / PNP (Source)	
		Definition : Run/Stop, Reset, External Trip, DC Brake, 3-Wire, Up-Down, etc.	
Output	Run/Stop Type	State of Drive	Below DC 24V 50mA
	Frequency Setting		(N.O., N.C.) Below AC250V 1A , Below DC30V 1A
	Functions	0 ~ 10 Vdc (Below 10mA) : Selectable between Frequency, Current, Voltage and DC Voltage	

Application

Theater System

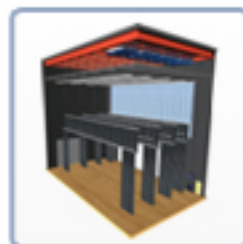

Overall

- Drive controls flying batters which carry Lights, Flags, Stage boards move vertically

Features

- Regenerative energy from the heavy loads has to be controlled
- Depending on the situation, single position control or proportional position control are required

Requirements & Solution

- Electro-mechanical brake control
 - iS7 Brake Control Function
- Zero-speed Control
 - iS7 Vector Control Mode
- High-speed Communication
 - iS7 Ethernet-IP Option
- Position Control
 - iS7 Position Control Option

Configuration

