

Rail Mounting Base "RMA-E2"

Thank you for purchasing this rail mounting base "RMA-E2." This base allows you to install your FRENIC-Ace on the DIN rail (35 mm wide).

1. Check that:

- (1) The rail mounting base is contained in the package.
- (2) The rail mounting base is not damaged or dented during transportation.
- (3) The rail mounting base is the model you ordered. Check the model name (see the table below) printed on the nameplate (shown on the right).
- (4) Check that the package contains the following mounting screws.
 - RMA-E2-0.75: M4x10 (2)
 - RMA-E2-2.2 or RMA-E2-3.7: M4x12 (4)
 If you suspect that the product is not working properly, or if you have any questions about the product, contact the shop where you bought the product or your local FUJI branch office.

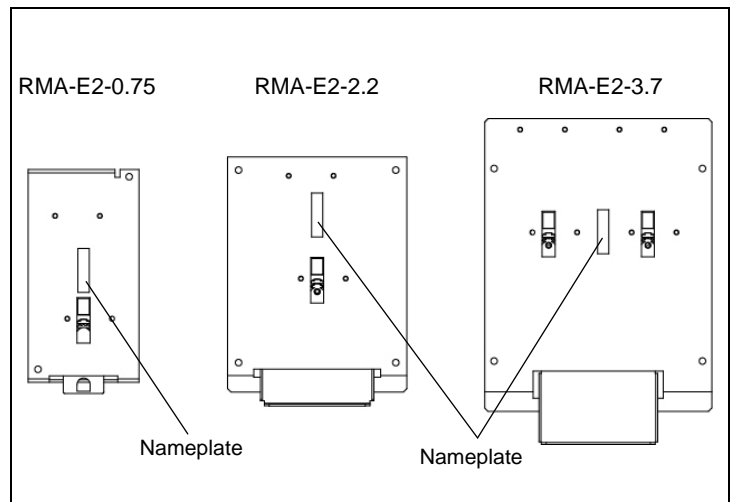

2. Rail Mounting Base Models and Applicable Inverter Models

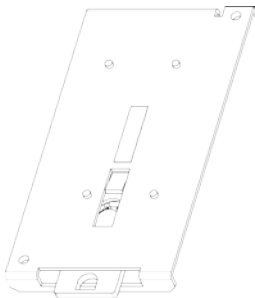
Rail Mounting Base Models	Applicable Inverter Models
RMA-E2-0.75 	FRN0001E2S-2GB FRN0002E2S-2GB FRN0004E2S-2GB FRN0006E2S-2GB FRN0001E2S-7GB FRN0002E2S-7GB FRN0003E2S-7GB FRN0005E2S-7GB

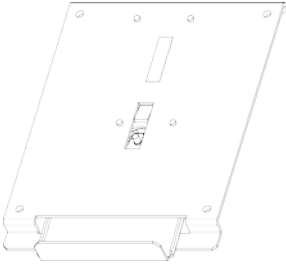
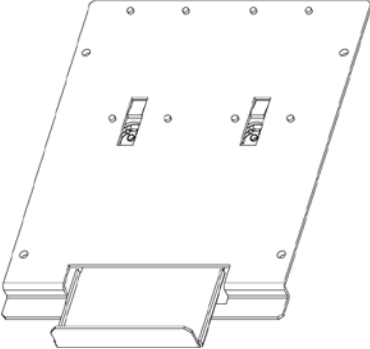
Rail Mounting Base Models	Applicable Inverter Models
RMA-E2-2.2 	FRN0010E2S-2GB FRN0020E2S-2GB FRN0002E2S-4GB FRN0004E2S-4GB FRN0006E2S-4GB FRN0007E2S-4GB FRN0008E2S-7GB
RMA-E2-3.7 	FRN0020E2S-2GB FRN0012E2S-4GB FRN0011E2S-7GB

3. Precautions on Usage

- (1) In environments where the FRENIC-Ace may be subjected to vibration or impact, use of the FRENIC-Ace installed on the rail is not permitted.
- (2) Installation of the FRENIC-Ace with a rail mounting base is permitted only when the FRENIC-Ace is to be installed vertically.
- (3) When installing the FRENIC-Ace series of inverters together with other devices on the same rail, maintain a space of at least 10 mm between them. However, provided that you are installing the FRENIC-Ace series of inverters only, and the ambient temperature is 40 °C or below, side-by-side installation with no gap in between is possible.

4. Installation Procedure

- (1) Installing the rail

Secure the rail (on which you want to set up your FRENIC-Ace) with mounting screws at intervals of a maximum of 200 mm (100 mm or less recommended).

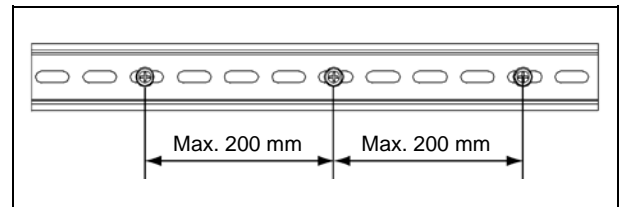

(2) Installation/removal procedure

■ RMA-E2-0.75/RMA-E2-2.2/RMA-E2-3.7

Installing the rail mounting base on your FRENIC-Ace

- 1) As illustrated below, set the inverter so that the bottom comes to the handle on the rail mounting base.
- 2) Secure the inverter to the rail mounting base with the screws provided (Tightening torque: 1.8 N•m)

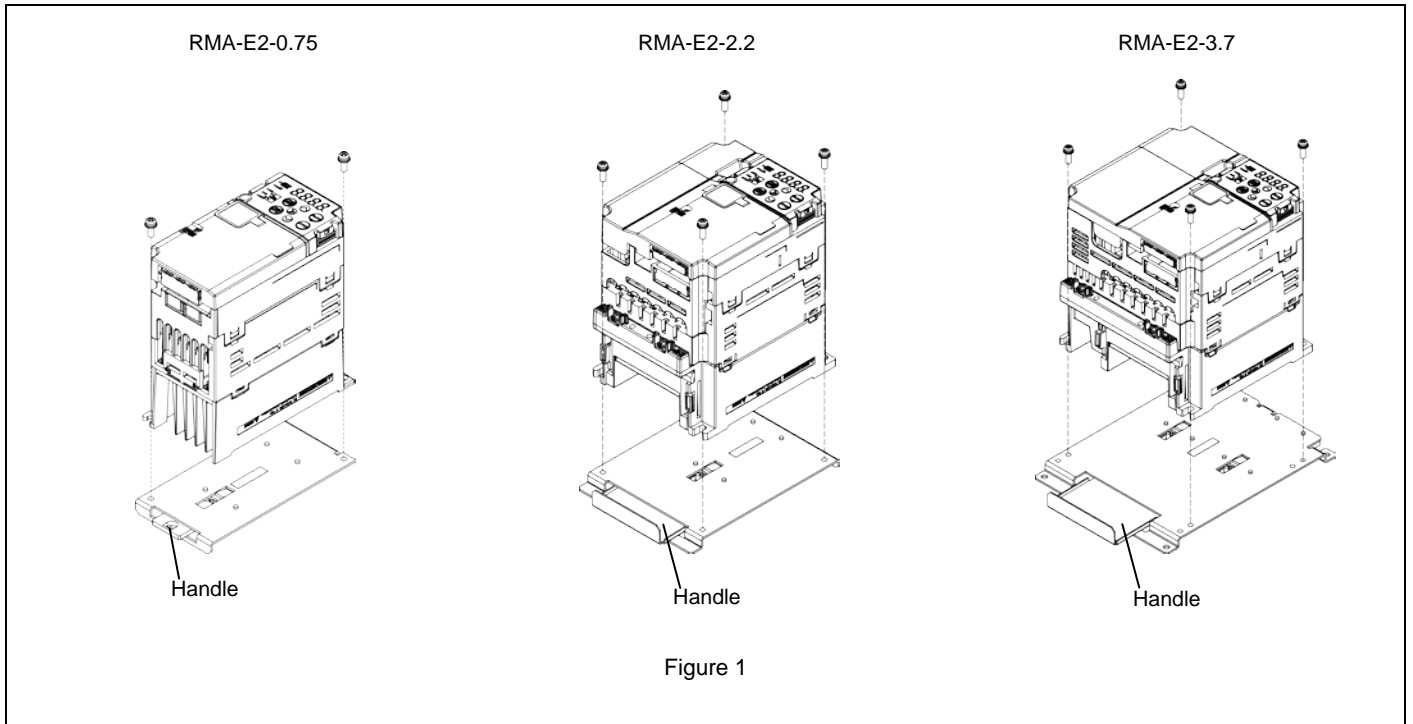

Installing the rail mounting base with the FRENIC-Ace to the rail

- 1) Hook the upper latches of the rail mounting base over the upper edge of the rail.
- 2) Press the lower end of the FRENIC-Ace against the rail until the lower latches of the rail mounting base catch onto the rail.

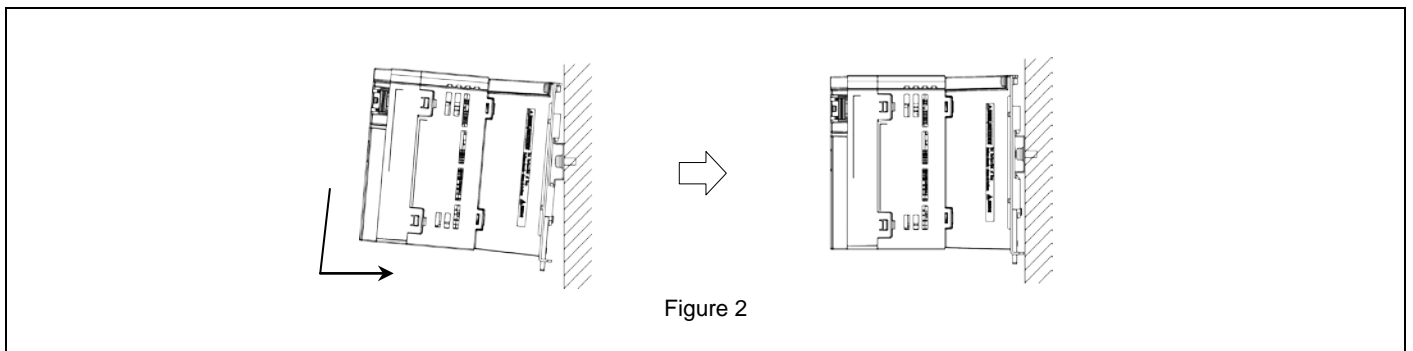

Removing the rail mounting base with the FRENIC-Ace from the rail

- 1) While holding the FRENIC-Ace by hand, turn the handle of the rail mounting base clockwise or counterclockwise, and pull the lower end of the FRENIC-Ace towards you to release it from the lower latches of the rail.

 **CAUTION** Be sure to support the FRENIC-Ace when carrying out this procedure. Failure to do so may result in the FRENIC-Ace being dropped.

- 2) Lift up the FRENIC-Ace and release the rail mounting base and FRENIC-Ace from the rail.

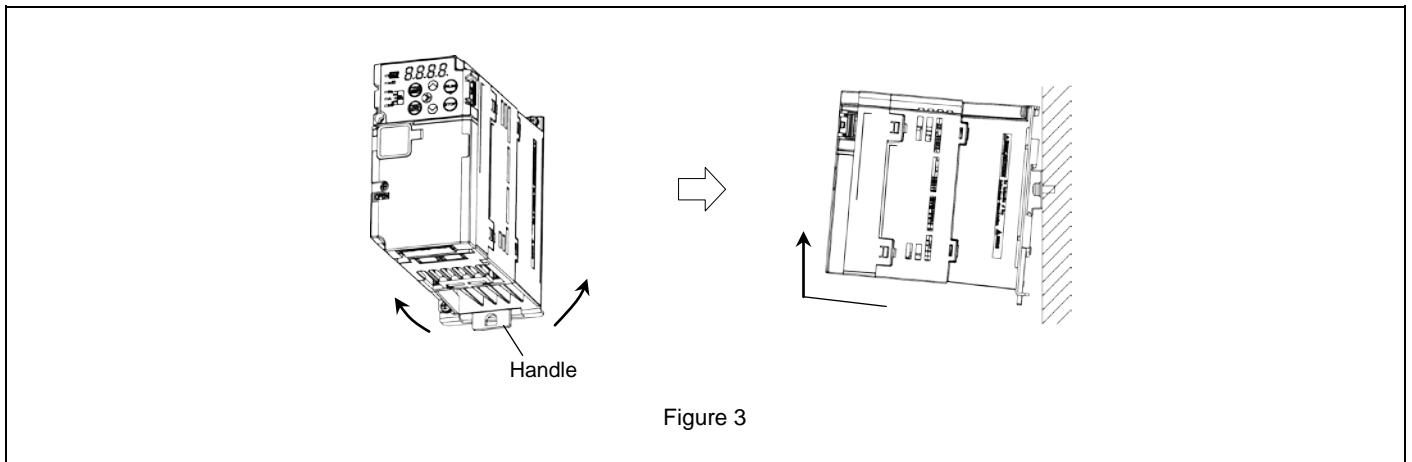

Fuji Electric Co., Ltd.

Gate City Ohsaki, East Tower, 11-2, Osaki 1-chome, Shinagawa-ku, Tokyo 141-0032, Japan

Phone: +81 3 5435 7058 Fax: +81 3 5435 7420

URL: <http://www.fujielectric.com>