

SHS Series

Switching diagram

1 NC contact
(Type B)

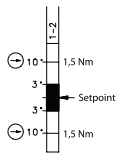

1 Changeover contact
(Type C)

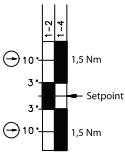

Setting point freely selectable
in range from 0°... 225°

Tolerances:

Switching angle (opening) +2.0°/-1.5°

Positive opening torque 10 %

Positive opening angle +0.5°/-3°

Switching angle hysteresis (closing of normally-closed contact -1.0°)
from typical hinge switch-off point

Connection drawing

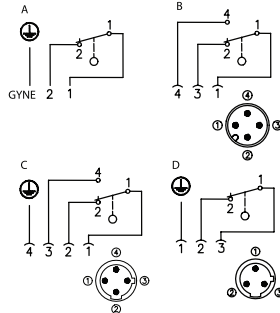

Connection variant 1

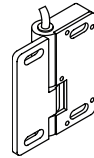

Cable, PVC

Connection variant 2

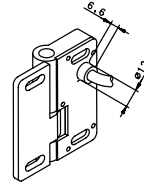

Cable, PVC

Connection variant 3

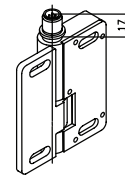

Connector M12 x 1,
metal thread

Connection variant 4

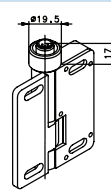

Connector M12 x 1,
metal thread

Connection variant 5

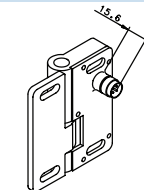

Connector M12 x 1

Connection variant 6

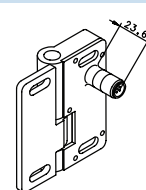

Connector M12 x 1

Product selection

Article number	Designation	Switching contact	Max. switching voltage	Type of voltage	Type of connection and direction radial	axial	Required cable coupling/type	Remarks
601.9261.011	SHS-A1Z-KA 5	1NC	230 V	AC/DC				BG approval
601.9261.014	SHS-A1Z-KR 5	1NC	230 V	AC/DC				BG approval
601.9261.017	SHS-A1Z-SA-BG	1NC	230 V	AC/DC		M12	A	BG approval
6019261018	SHS-A1Z-SR-BG	1NC	230 V	AC/DC		M12	A	BG approval
601.9261.009	SHS-A1Z-SA	1 Changeover contact	230 V	AC/DC		M12	C	
601.9261.010	SHS-A1Z-SR	1 Changeover contact	60 V	DC		M12	B	
601.9261.015	SHS-A1Z-SA	1 Changeover contact	60 V	DC		M12	B	
601.9261.016	SHS-A1Z-SR	1 Changeover contact	230 V	AC/DC		M12	C	
6019291013	SHS-OZ							Blank hinge

Technical data

Electrical data		
Rated insulation voltage	U_i	250 V
Rated surge voltage strength	U_{imp}	2.5 kV
Thermal current	I_{the}	3 A
Rated operating voltage	U_e	230 V AC; 60 V DC
Utilization category		AC-15, 230 V AC/1.5 A;
Positive opening	p	conforming to IEC/EN 60947-5-1, Addendum K
Short-circuit protection		Fuse 4 A gL/gG
Mechanical data		
Switch		GD-Zn
Ambient temperature		-25°C to +70°C (Connection cable installed)
Mechanical service life		10 ⁵ switching cycles
B10d		2 mill.
Switching frequency		max. 1200 switching cycles/hour
Mounting		4x M6 screws DIN 7984 or DIN 6912
Type of connection		Fixed connection cable, 3 x 0.5 mm ² x 5 m (AWG20), minimum bending radius = 25 mm
Weight		approx. 0.7 kg (cable variant) approx. 0.4 kg (connector and blank hinge variant)
Installation position		Any
Protection class		IP67 as per IEC/EN 60529
Switching angle		± 3° from setting point
Positive opening angle		± 10° from setting point
Positive opening torque		1.5 Nm
Mechanical load		F_{R1} = max. 1000 N, F_{R2} = max. 500 N, F_A = max. 750 N
Standards		
VDE 0660 T100, DIN EN 60947-1, IEC 60947-1		
VDE 0660 T200, DIN EN 60947-5-1, IEC 60947-5-1		

Drawing dimensions in mm